

	<i>technical issue</i>	<i>description</i>	<i>notes</i>
1	CONSTRUCTION	ELITE 92 ALU	
2	MATERIAL	<ul style="list-style-type: none"> - pine fingerjointed, - pine sorted (not fingerjointed), - meranti, - oak, 	
3	FITTINGS OPTIONS	<ul style="list-style-type: none"> - tilt, turn, turn&tilt, tilt&turn, - flying mullion with espagnolette, - tilt with HAU-TAU opener (from floor level), - anti-burglar options: RC1, RC2, - tilt and slide, - balcony doors with low aluminium threshold, - hidden hinges, - TBT handle function (tilt before turn), 	
4	WINDOW SHAPE	<ul style="list-style-type: none"> - rectangle, - triangle, - trapezium, - rounded, - arched, 	
5	SIZE RANGES	<p>Sash width</p> <ul style="list-style-type: none"> - standard: 332 - 1547mm, - RC1: 396 - 1761mm, - RC2: 396 - 1511mm, <p>Sash height</p> <ul style="list-style-type: none"> - max 2600mm, <p>Note: proportion of sash width to sash height - 1.5 Max sash weight 130kg - (tilt, tilt&turn). Max sash weight 50kg - (turn). Max sash weight 80kg - (triangle, rounded, arched)</p> <p>Weight of 1m² of glass (1mm thickness) - 2.5kg</p>	
6	GLAZING UNITS	- glazing unit thickness 34 - 54mm - rectangle, trapezium, triangle shapes	
7	TIMBER FINISH	Final painting with water-based opaque paints or stains	
8	COLOUR	<ul style="list-style-type: none"> - opaque: RAL 9016 (white), - Stain: Pine TM367, Afrozozja TM4239, Mahogany TM1530, Palisander TM1705, Teak TM1703, Cyprys TM5207, Venge TM9012, Nut TM1515, Graphite TM1504, 	
9	DRIP CAPS	Frame thermally broken drip cap, additional sash drip cap (standard) <ul style="list-style-type: none"> - white, brown, olive - other colours from RAL palette at request, 	
10	COVERS	fittings: hinge covers: white, olive	
11	GLAZING BARS	<ul style="list-style-type: none"> - construction (structural) bars 80mm, - vienna (glued-on) bars 12x24mm, - internal glazing bars (inside insulated glass unit), 	

	<i>technical issue</i>	<i>description</i>	<i>notes</i>
12	Widths of construction elements	<ul style="list-style-type: none"> - Sash element width: 80mm, - Frame element width: 83mm, 	
13	VENTS	<p>in sash:</p> <ul style="list-style-type: none"> a) Aereco EMM b) Trimvent 90 HL c) Aereco EXR <p>Note: External vent hood fitted on frame head.</p> <p>in frame:</p> <ul style="list-style-type: none"> a) Trimvent S13 b) Aereco EMM c) Ventair 	
14	ADDITIONAL OPTIONS	<ul style="list-style-type: none"> - frame widener, - frame connector, - 90 degree corner post, - 135 degree corner post, - counterprofile, - thresholds, <ul style="list-style-type: none"> a) Cutting 12x30 mm from outside and cutting 11x30mm from inside, b) Cutting 11x30mm from inside, c) Cutting 12x30 mm from outside, d) Cutting 12x30 mm from outside and cutting 11x14mm from inside, e) Cutting 12x30 mm from outside and groove 10x10mm from inside, f) without cutting, - timber cover bead (45mm, 35mm), 	
15	SILICONE	<ul style="list-style-type: none"> - transparent, 	

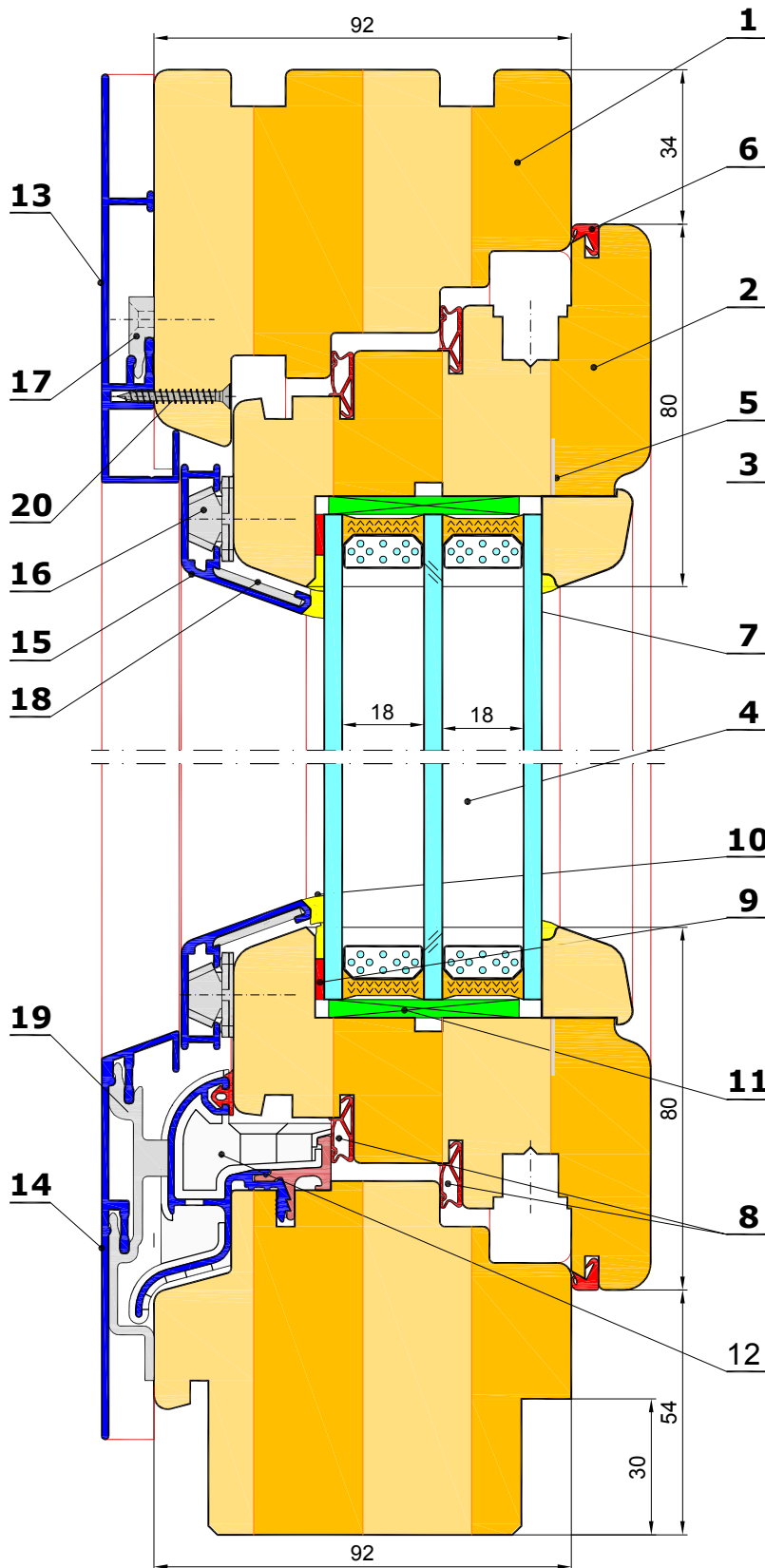

Zestawienie elementów

- 1 - Ościeznica okna - drewno
- 2 - Skrzydło okna - drewno
- 3 - Listwa przyszybowa - drewno
- 4 - Szyba zespolona
- 5 - Szyft stalowy
- 6 - Uszczelka krawędziowa
- 7 - Silikon wg DIN 1845 T.2 (grupa E)
- 8 - Uszczelka przylgowa
- 9 - Uszczelka neoprenowa
- 10 - Silikon wg DIN 1845 T.2 (grupa E)
- 11 - Podkładka z twardego PCV
- 12 - Okapnik rynnowy aluminiowy z wkładką termiczną
- 13 - Profil aluminiowy ościeznicy
- 14 - Profil alu. ościeznicy dolny
- 15 - Profil skrzydła aluminiowy
- 16 - Klips montażowy tworzywoy z podkładkami dystansowymi
- 17 - Uchwyt ramy ościeznicy
- 18 - Narożnik tworzyw. usztywniający
- 19 - Uchwyt ramy dolnej tworzywoy
- 20 - Wkręt z łbem stożk. ze stali nierdzewnej

Przekrój pionowy okna - ELITE 92 ALU

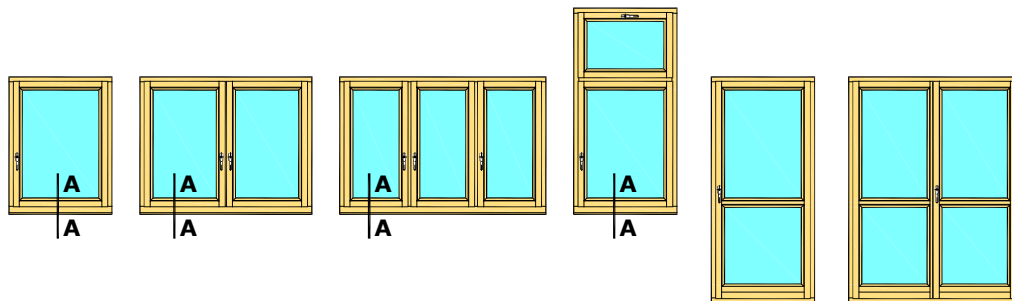

A-A

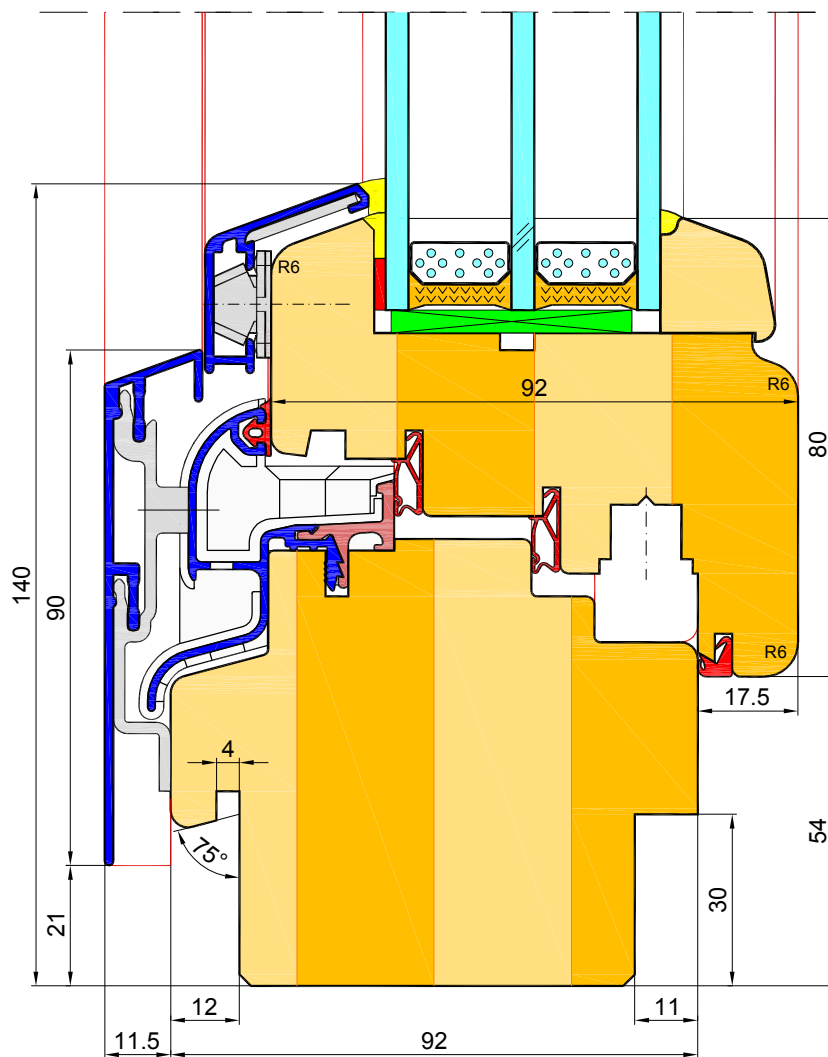

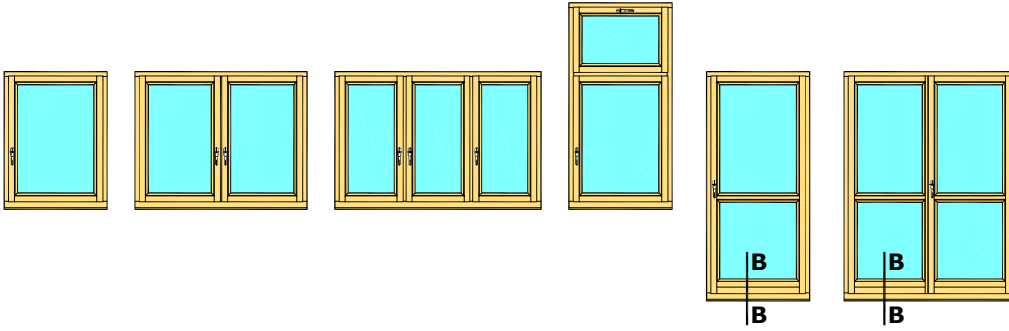

B-B

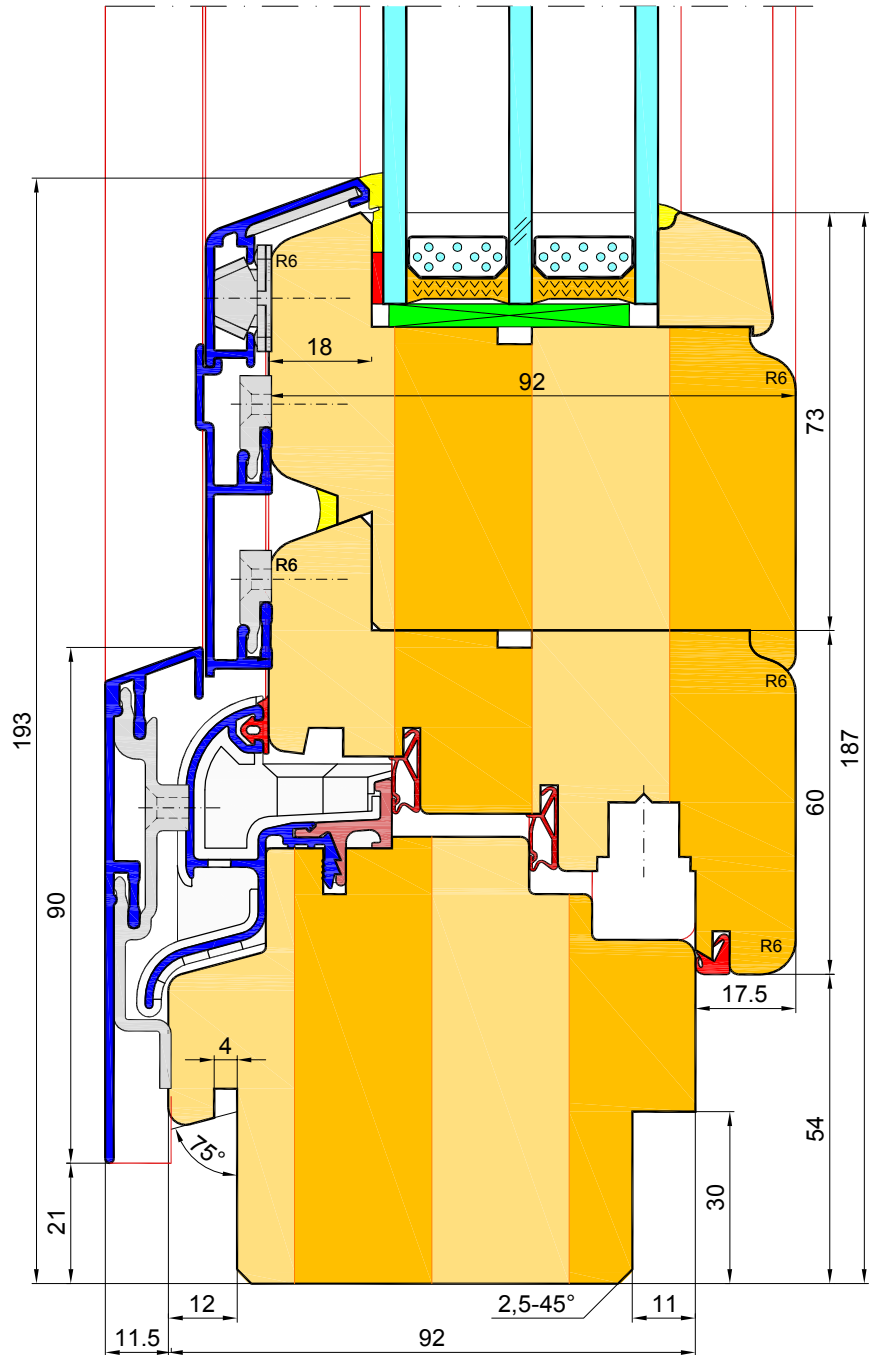

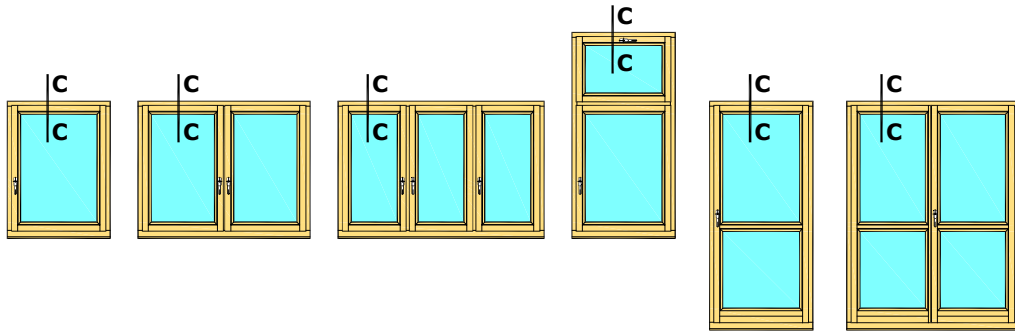

C-C

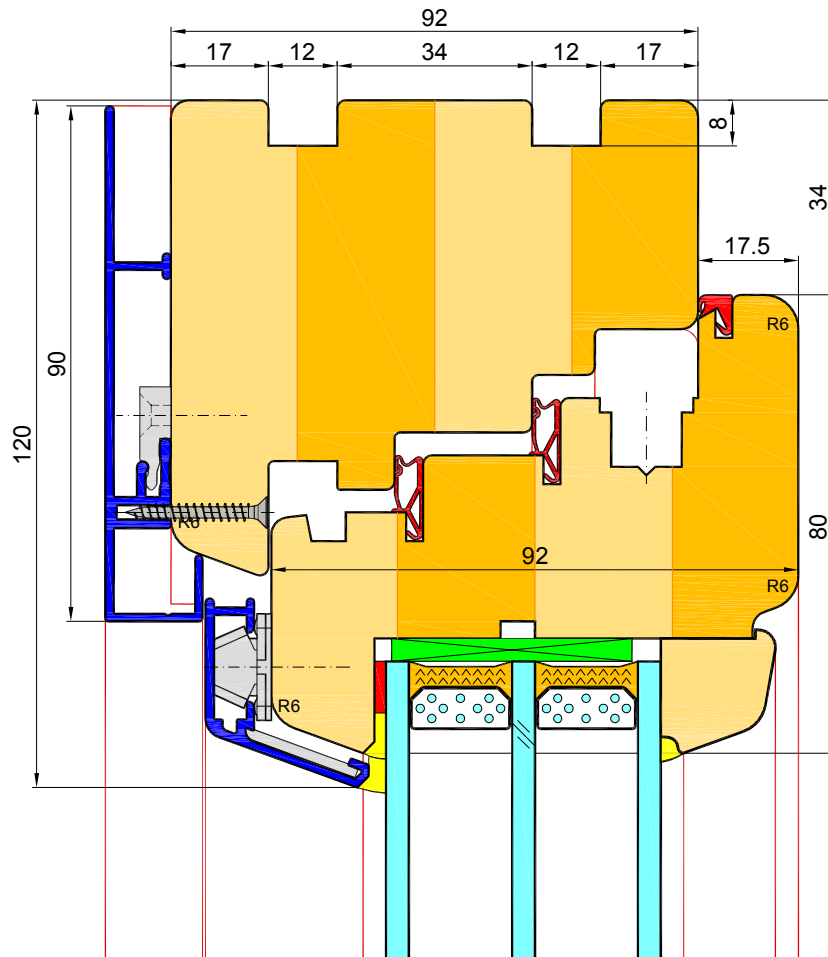

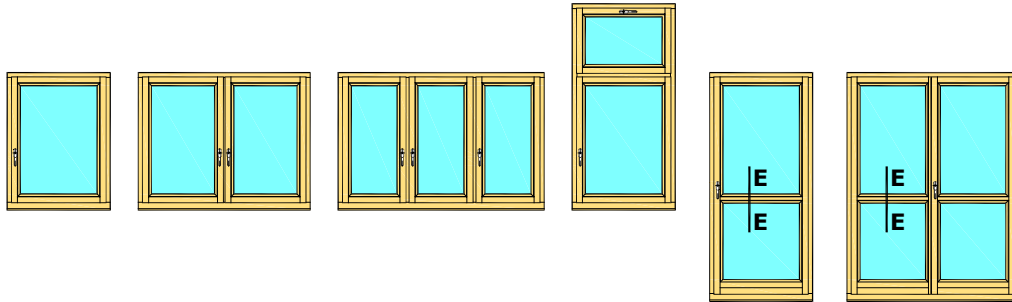

E-E

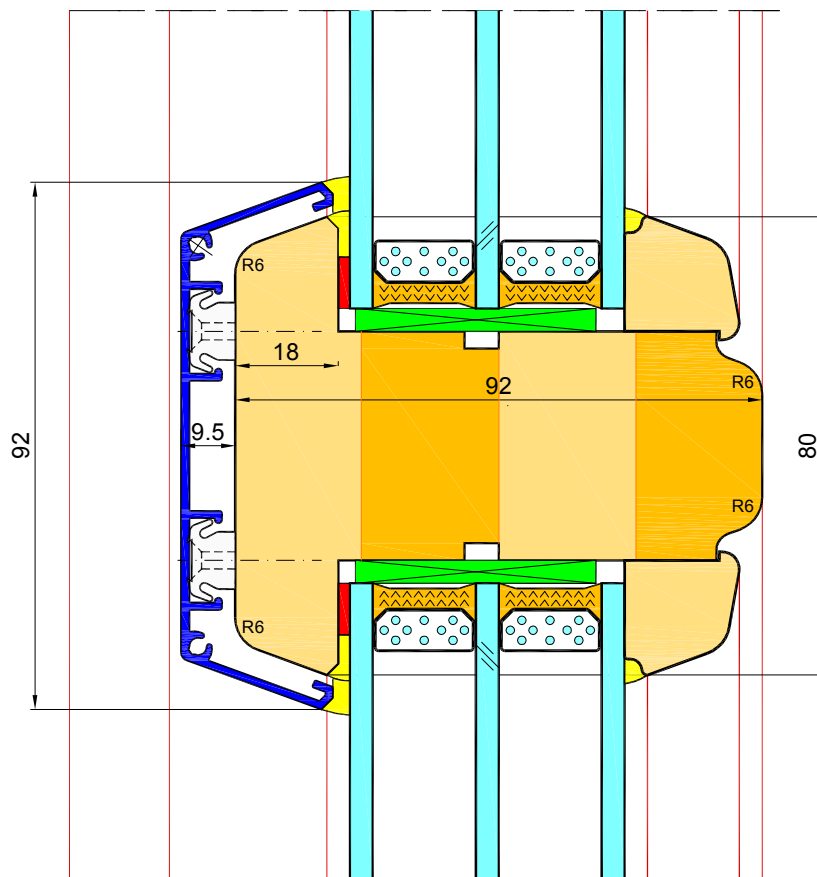

sash construction bar 80mm

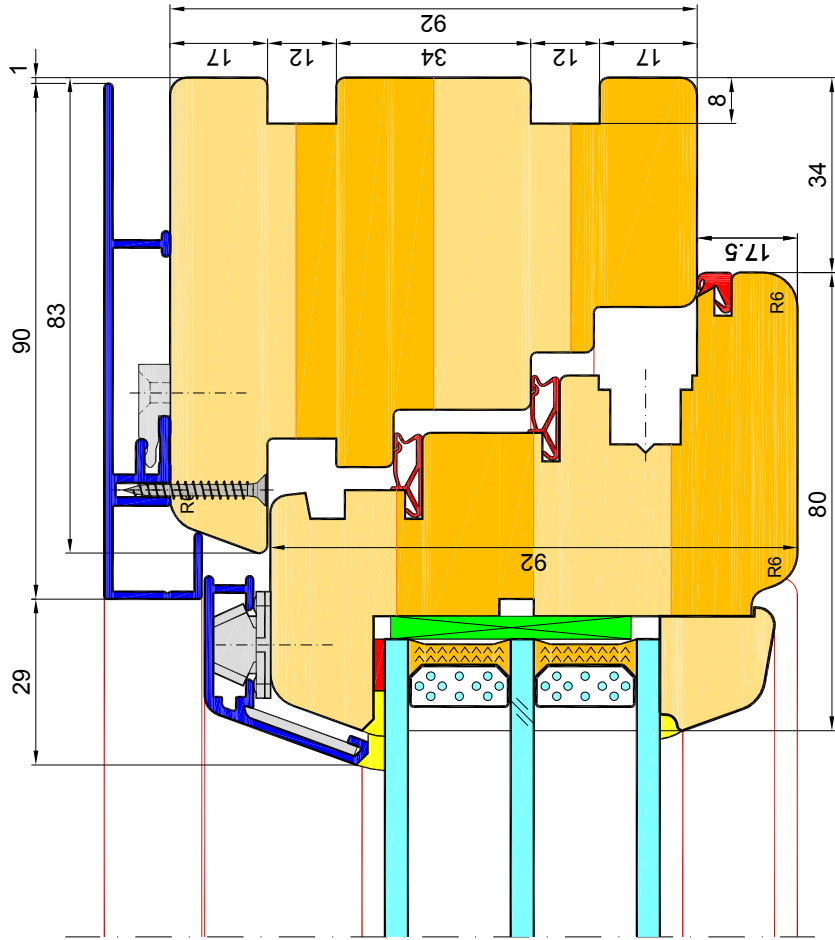
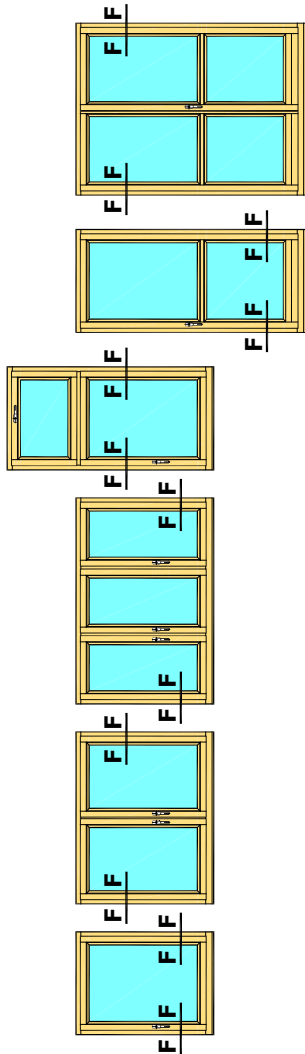

F-F

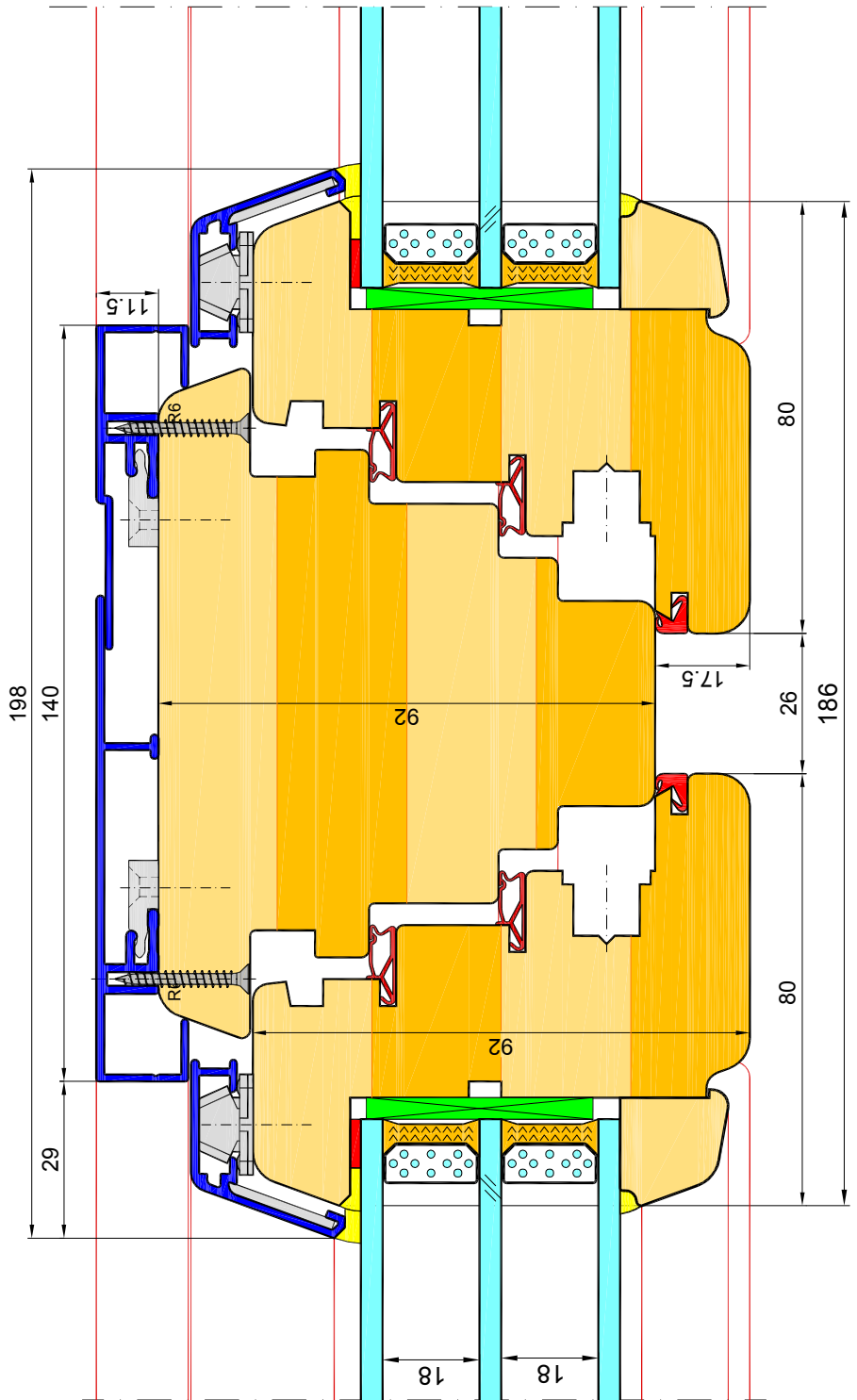
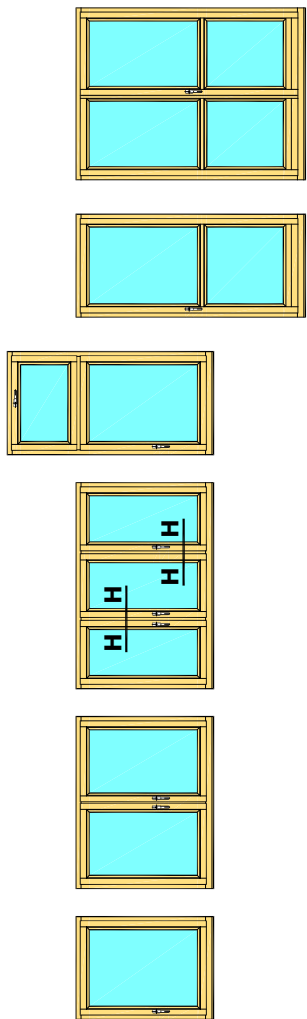

H-H

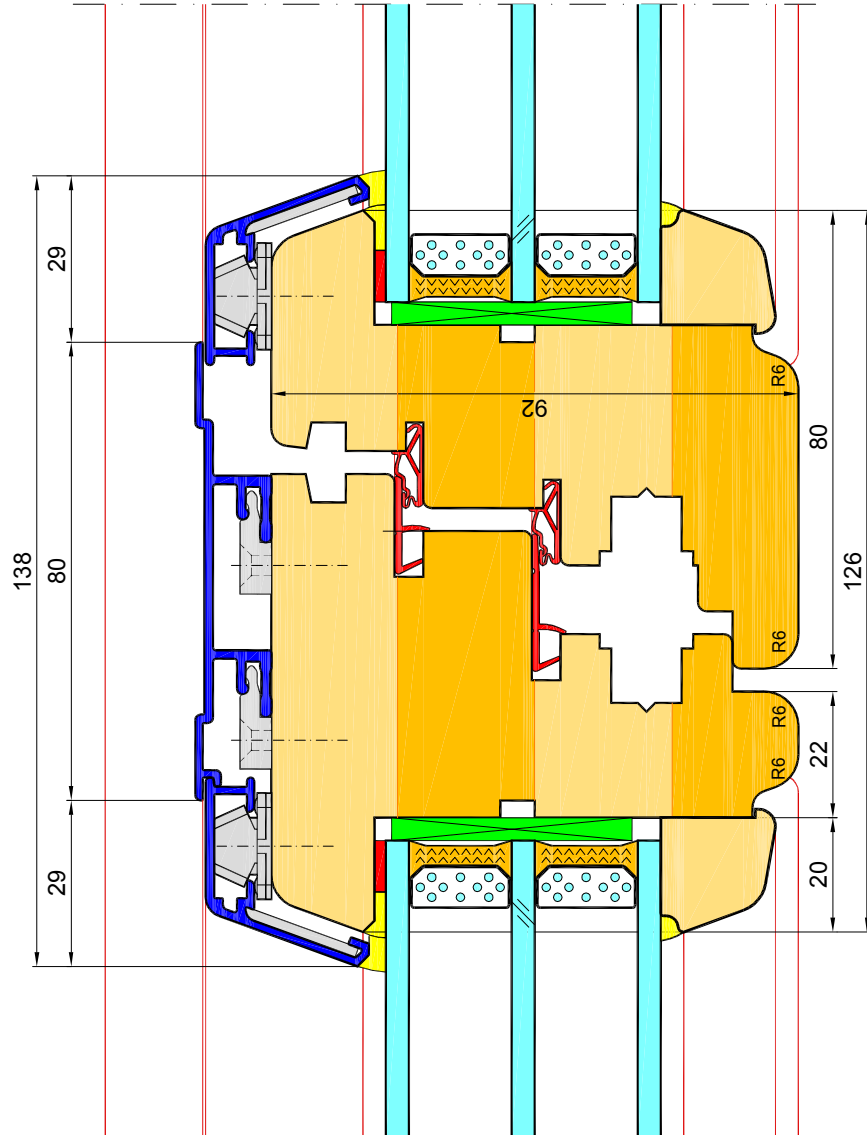
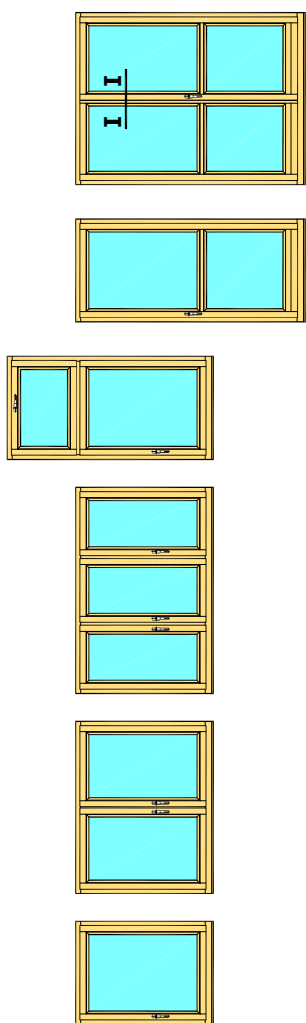

I-I

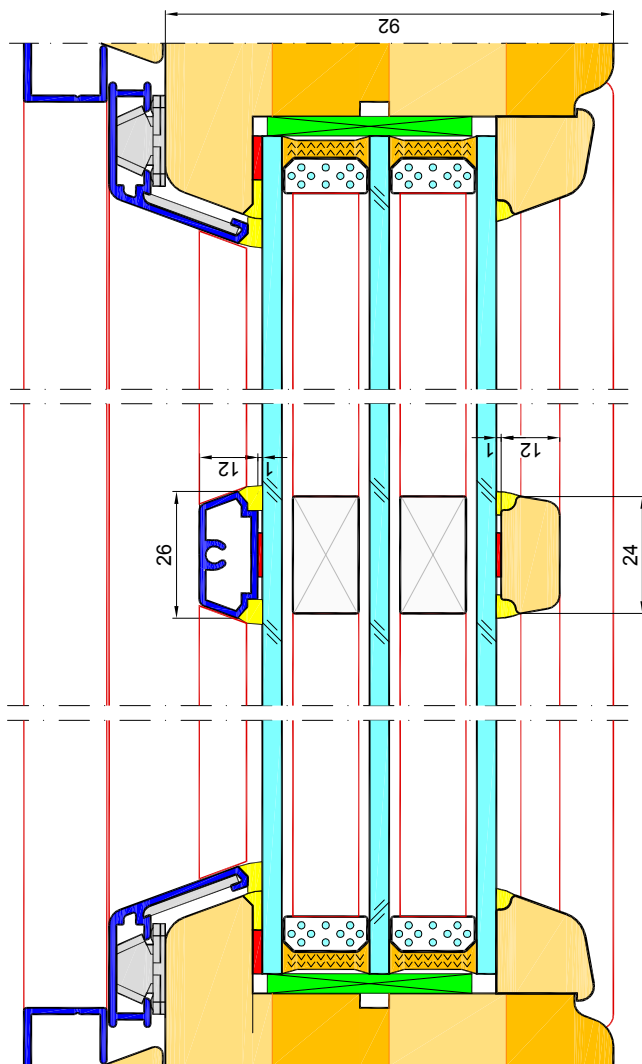
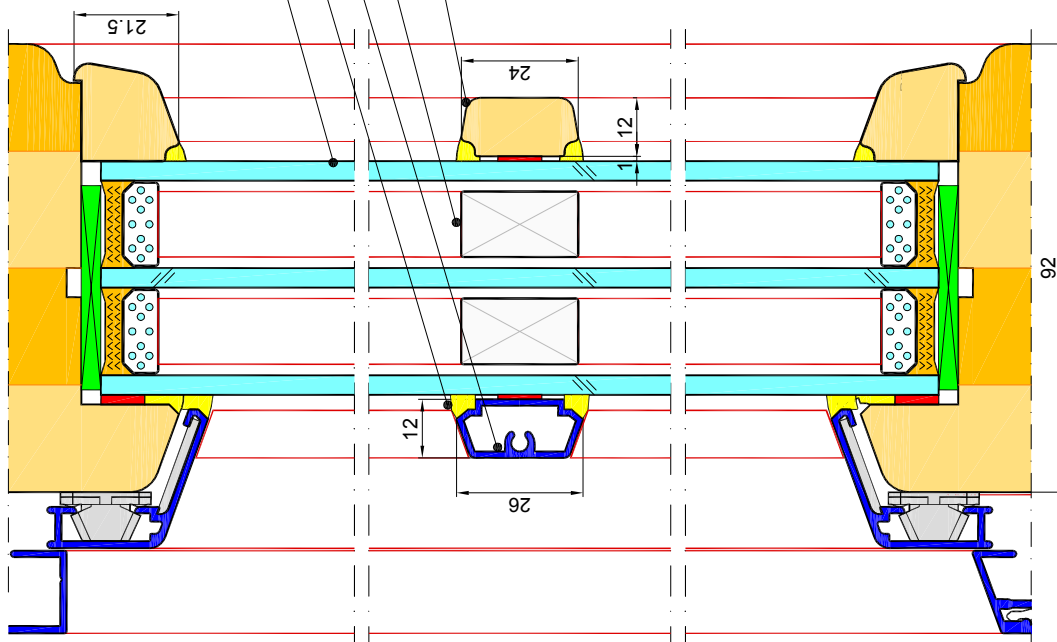
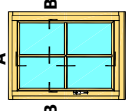
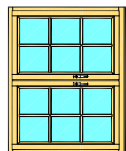
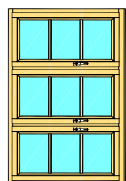
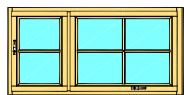
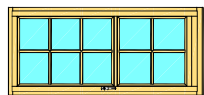
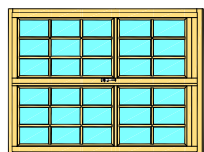
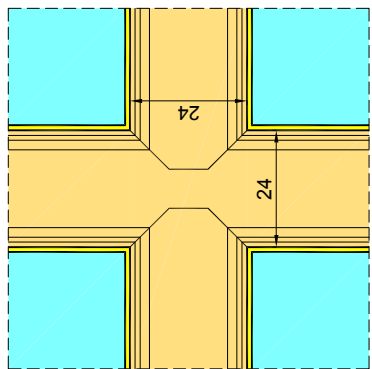

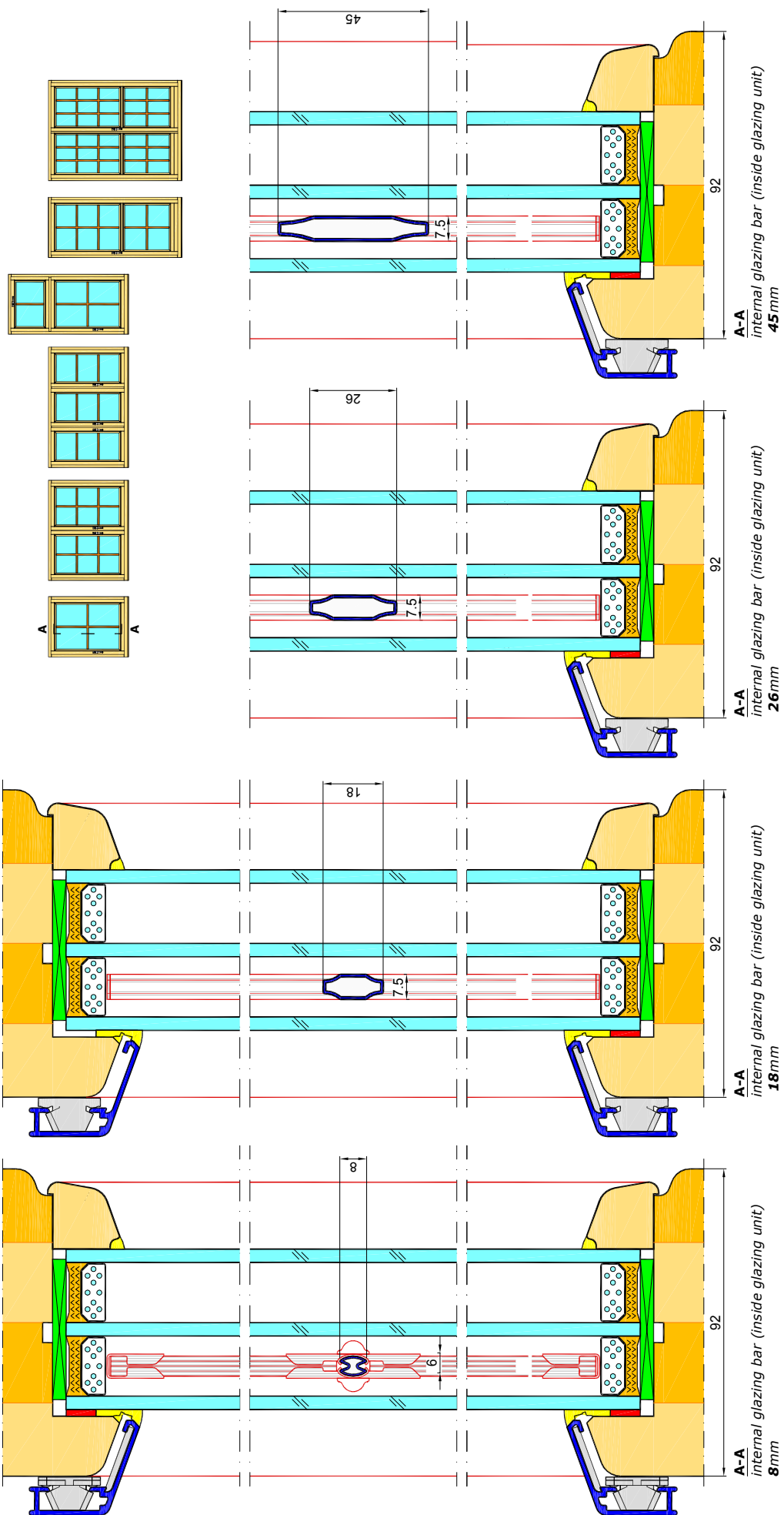

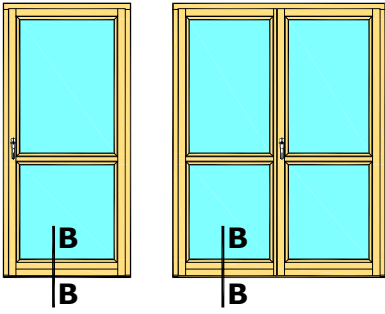

B-B

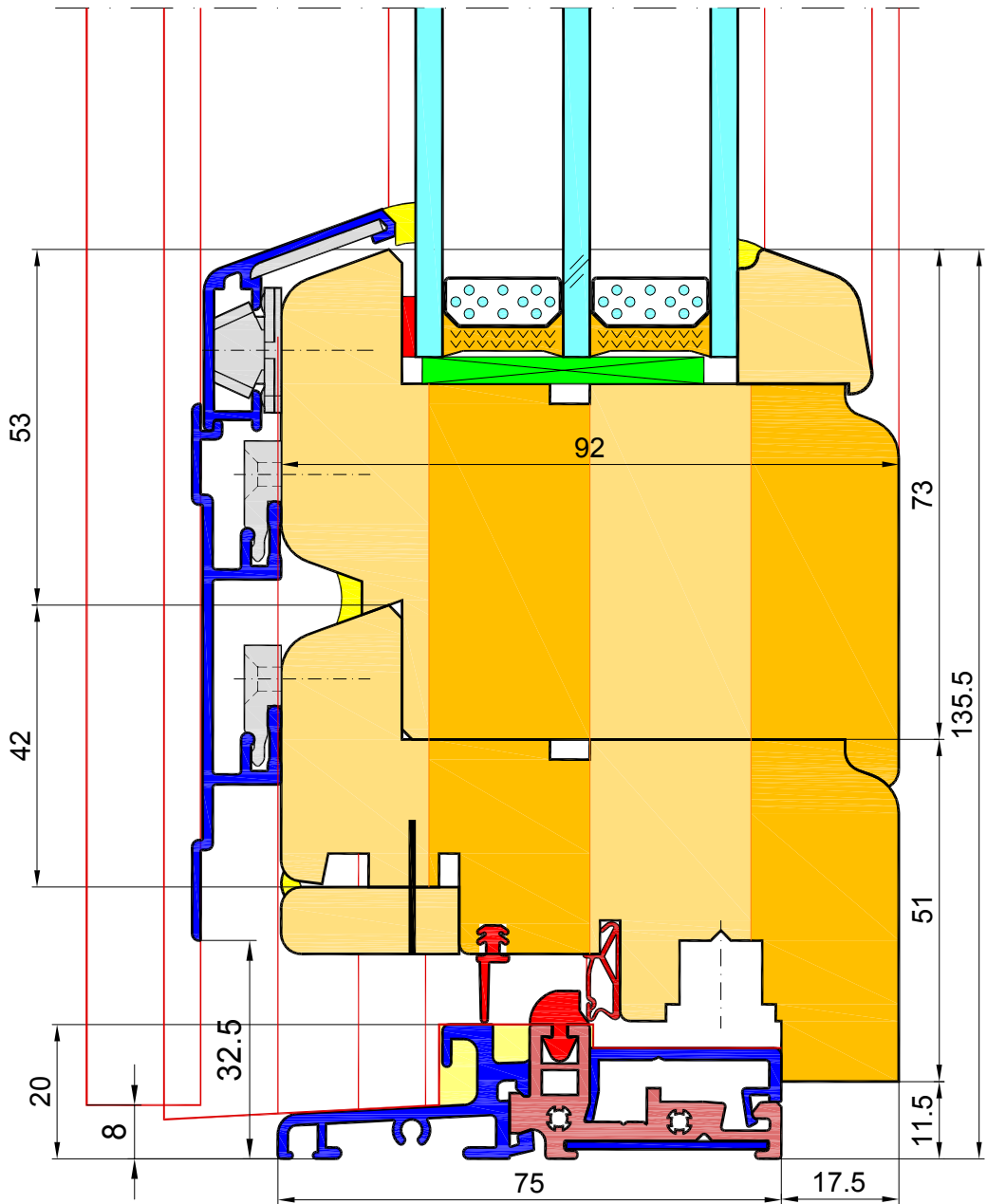

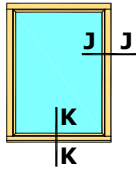

K-K

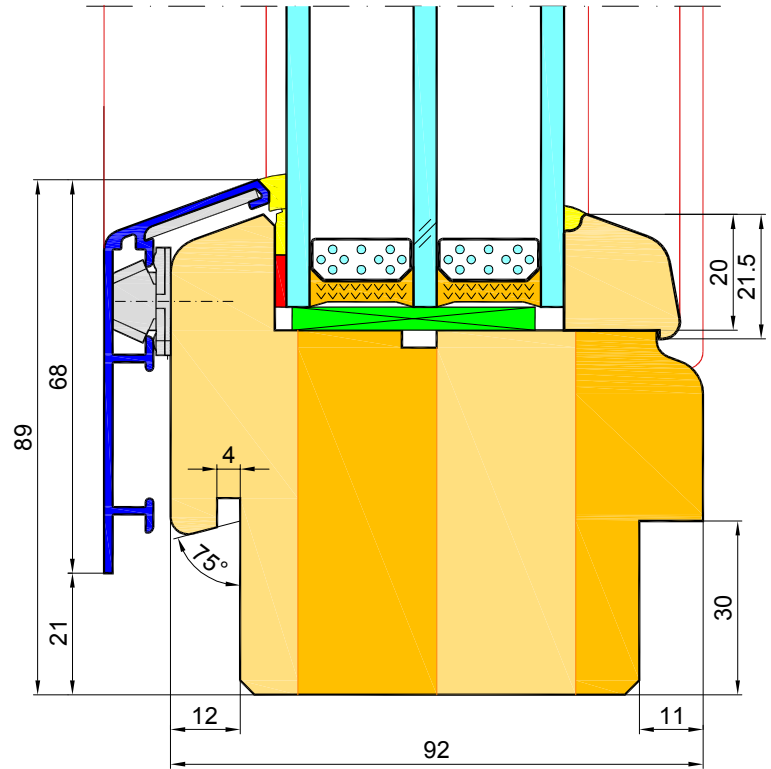

J-J

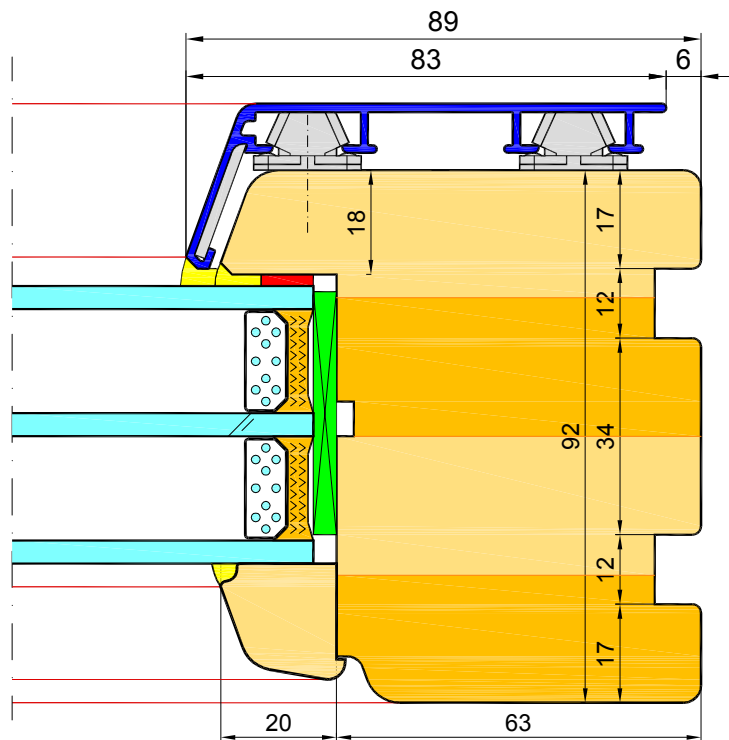

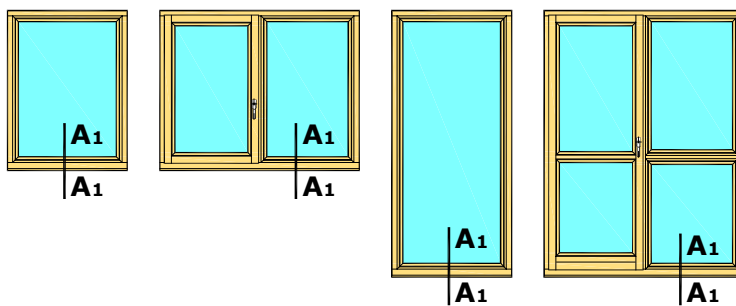

A1-A1

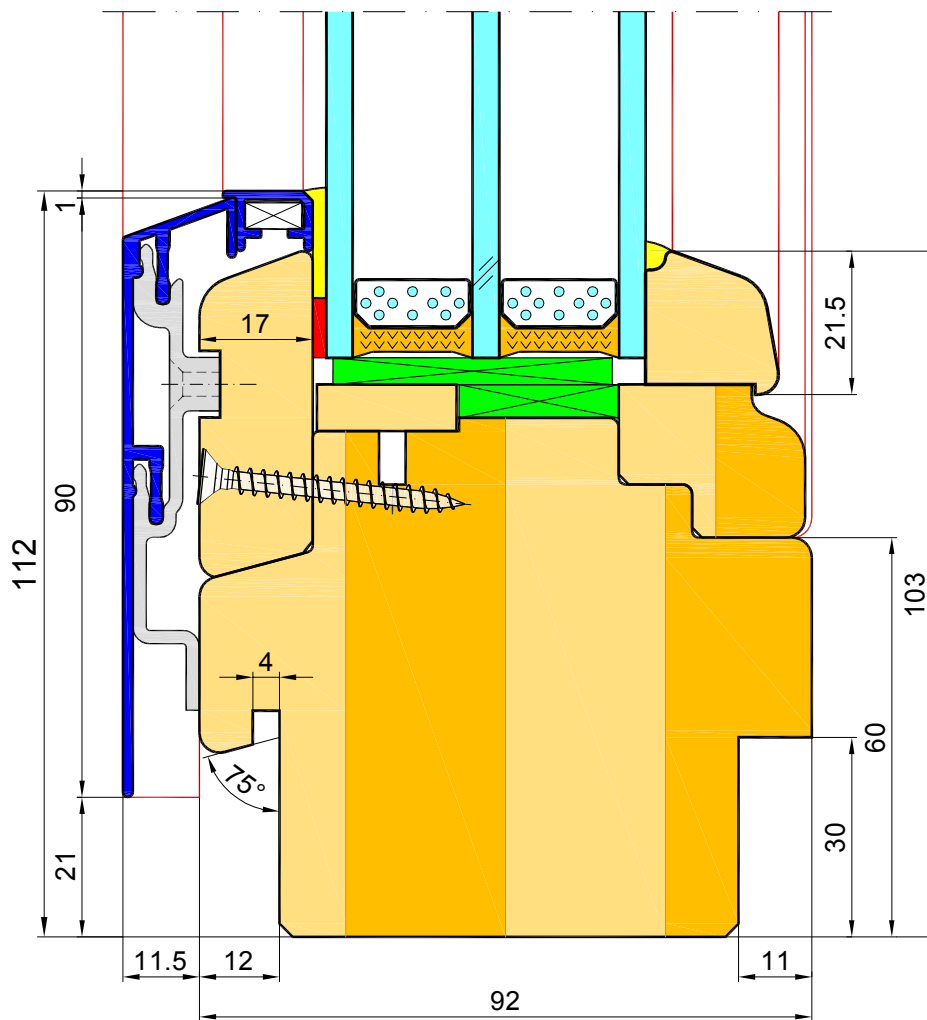

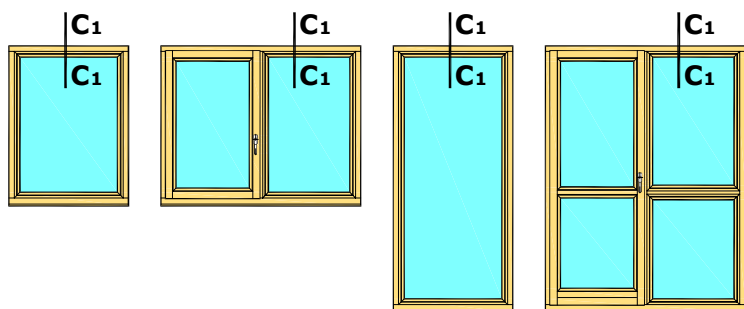

C1-C1

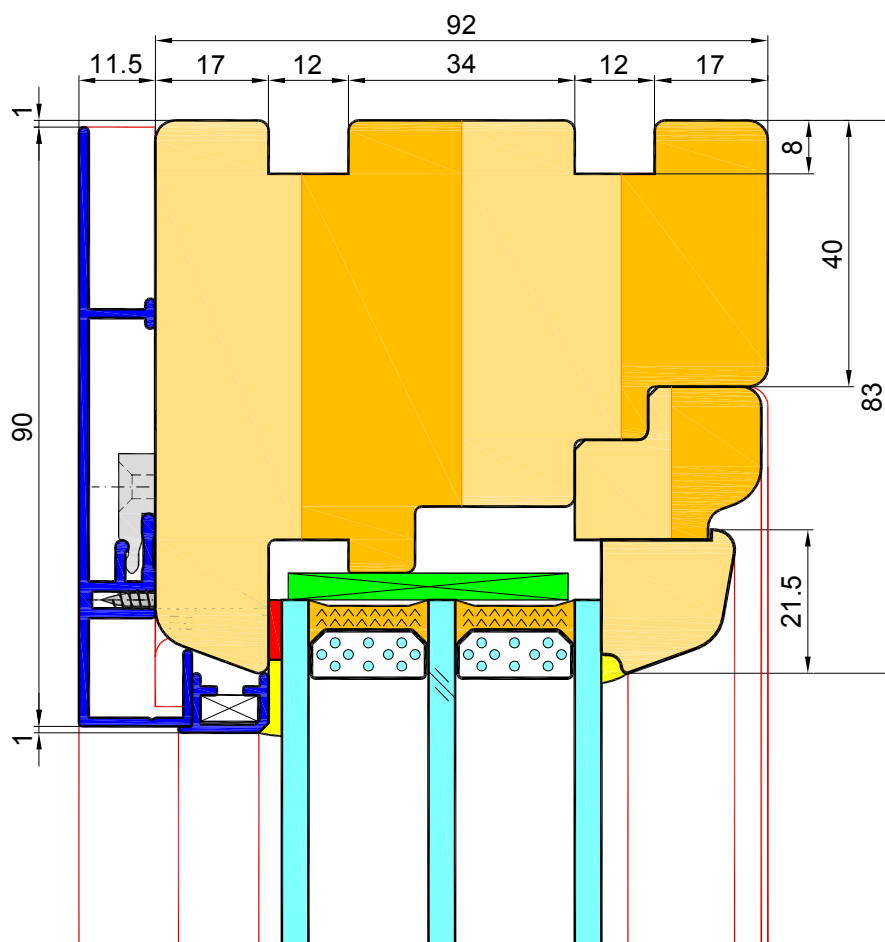

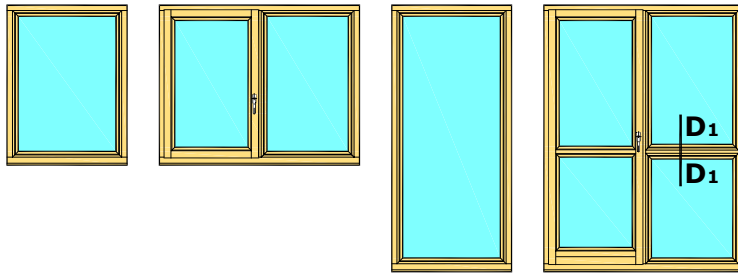

D₁-D₁

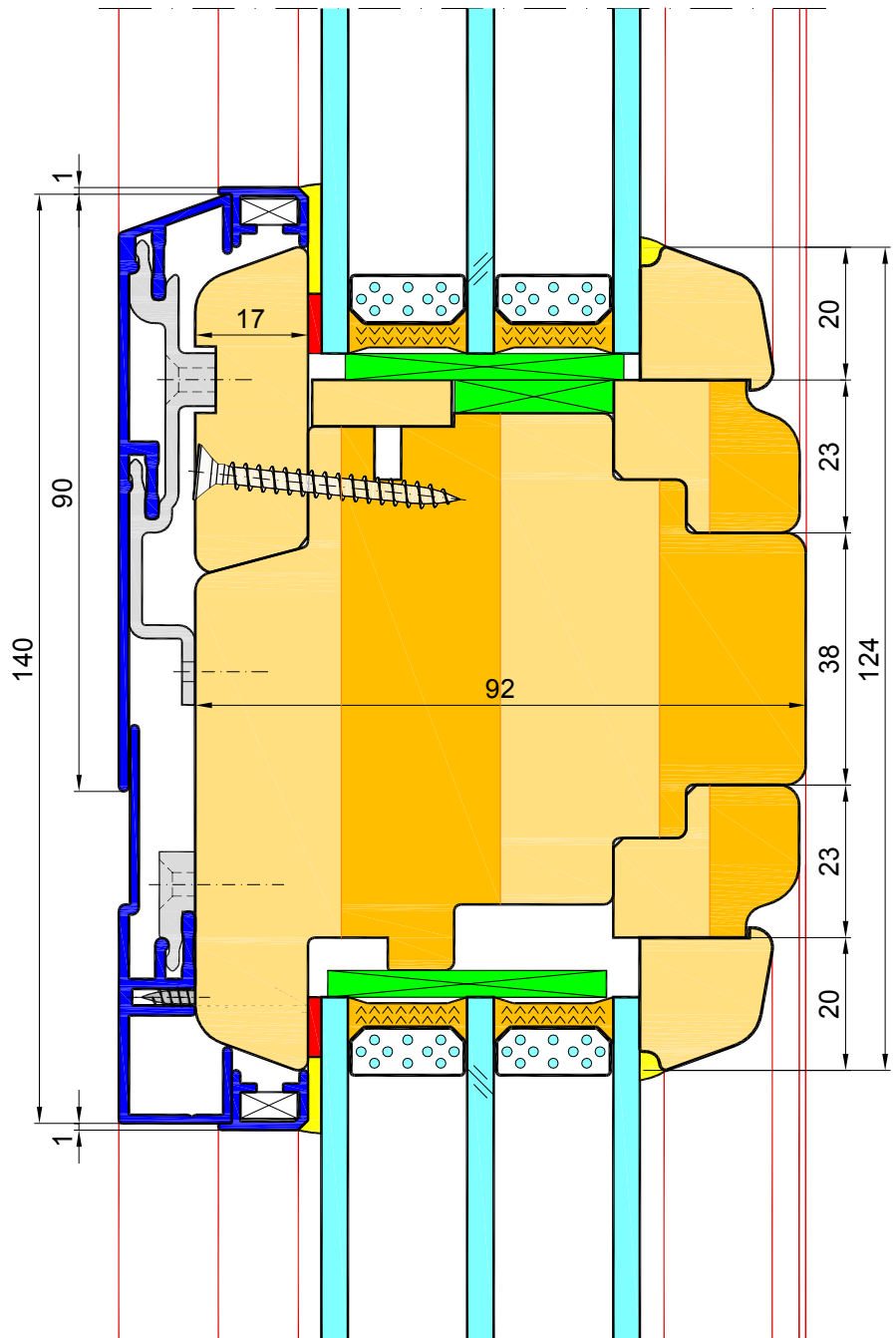

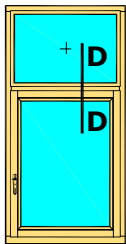

D - D



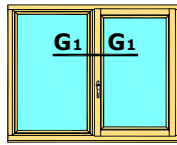
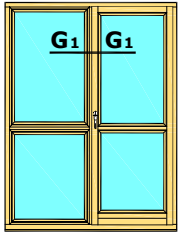

G1-G1

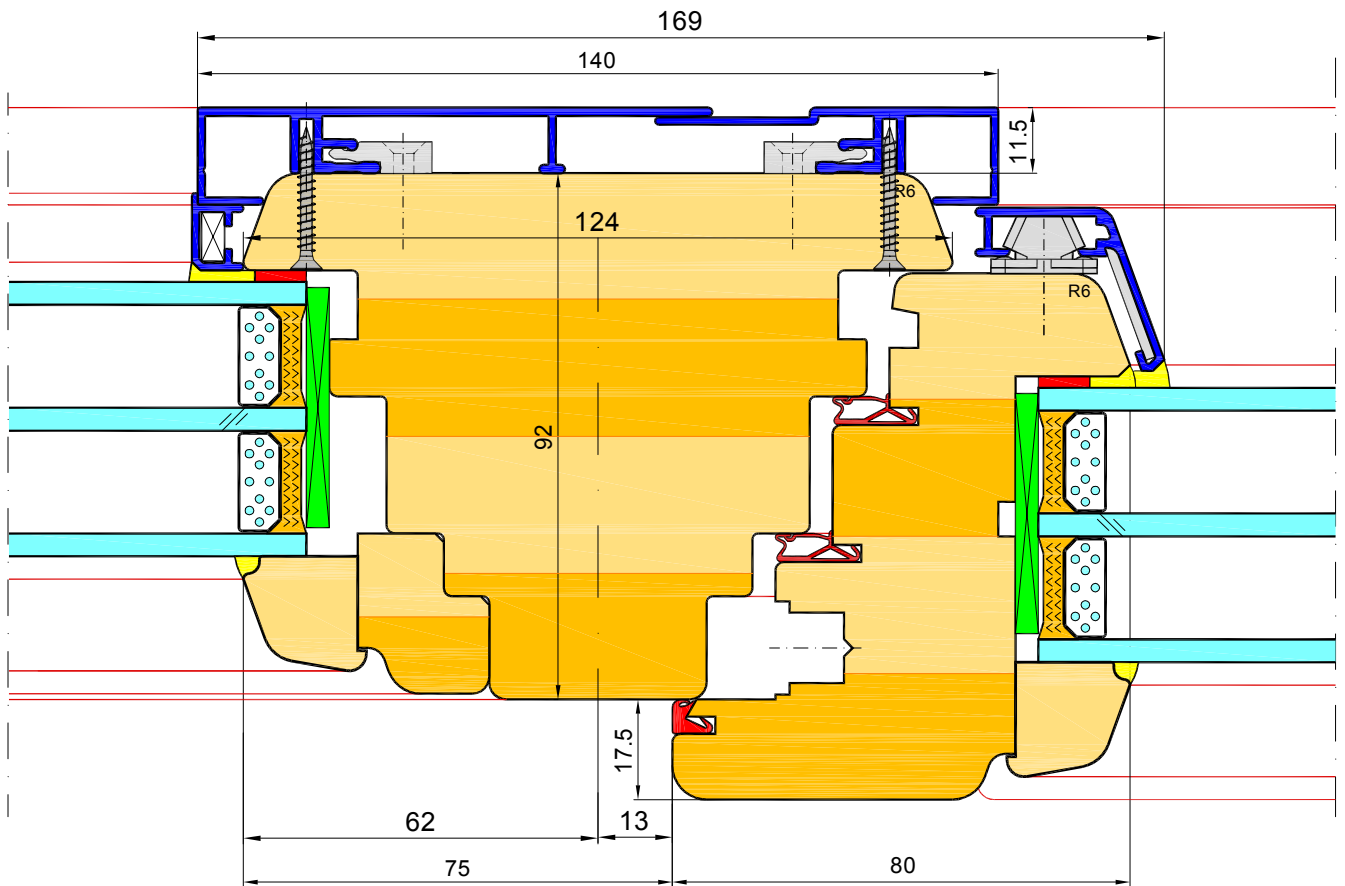

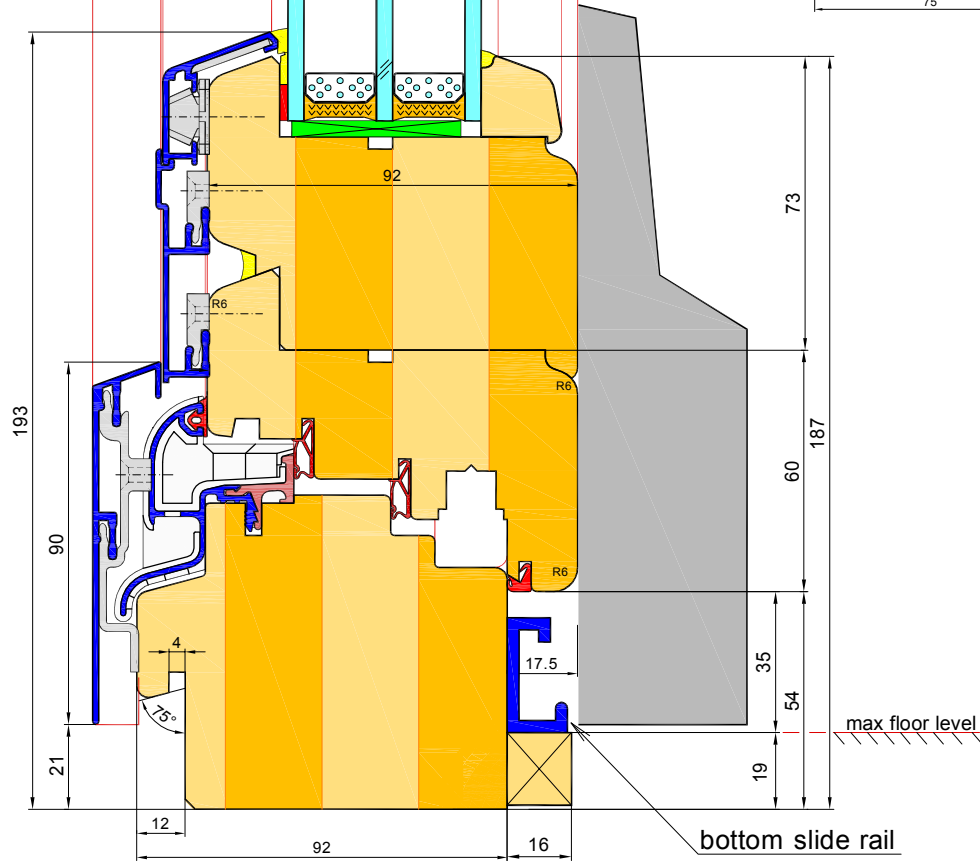
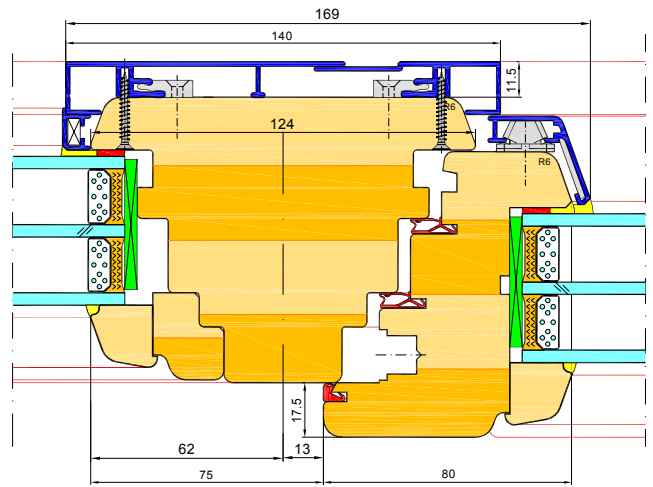
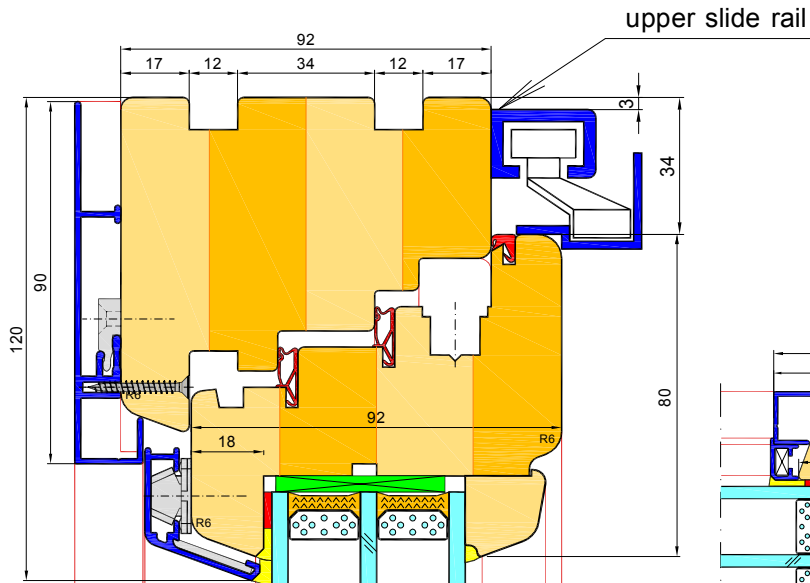
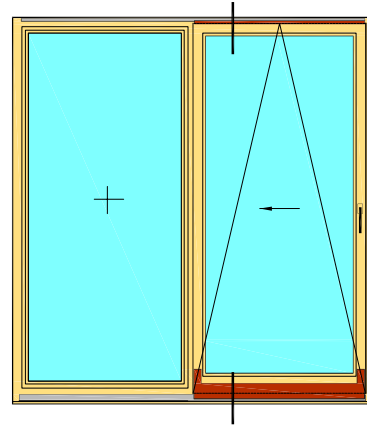

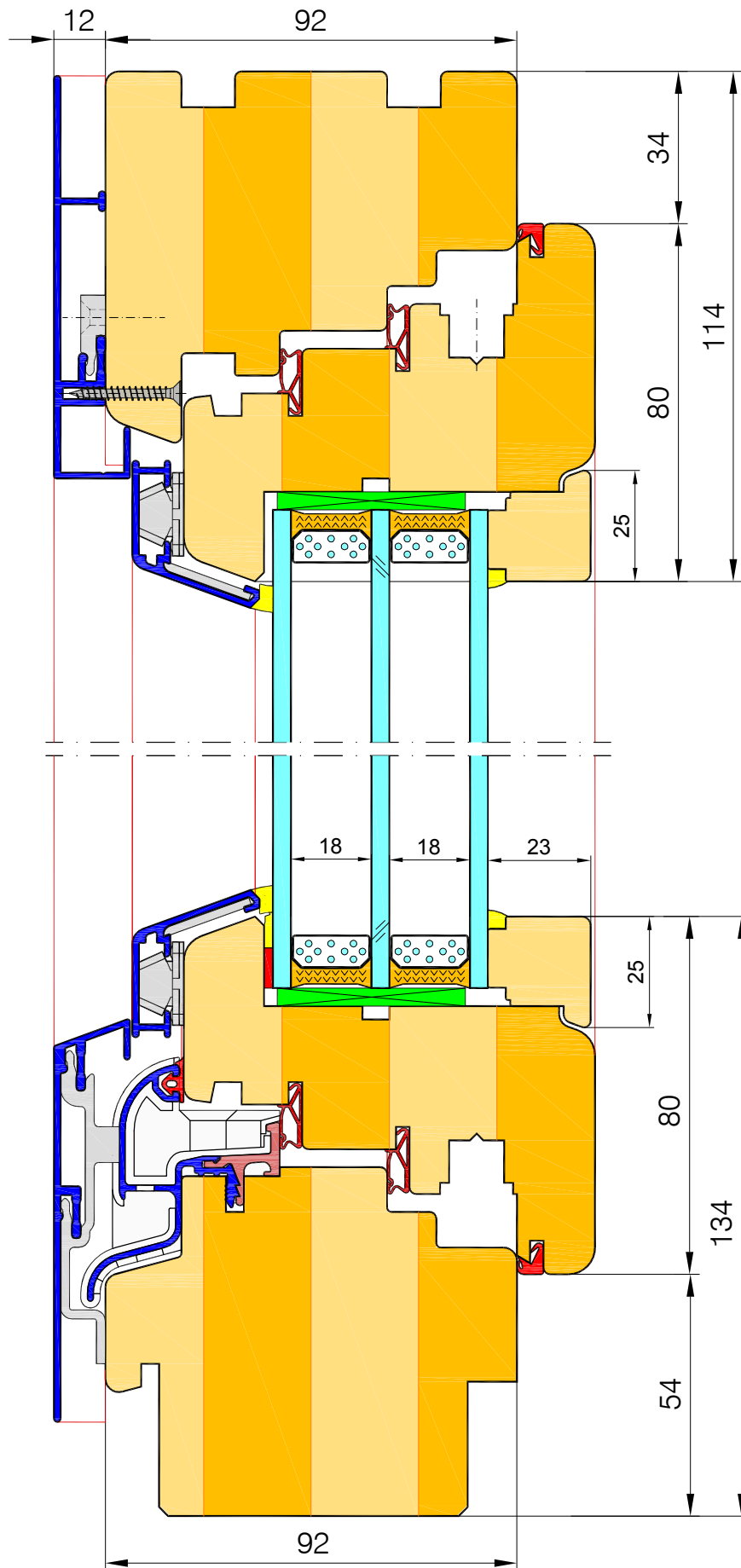

ELITE 92 ALU - Windows and balcony doors.
_ square glazing beads and square aluminium cladding .

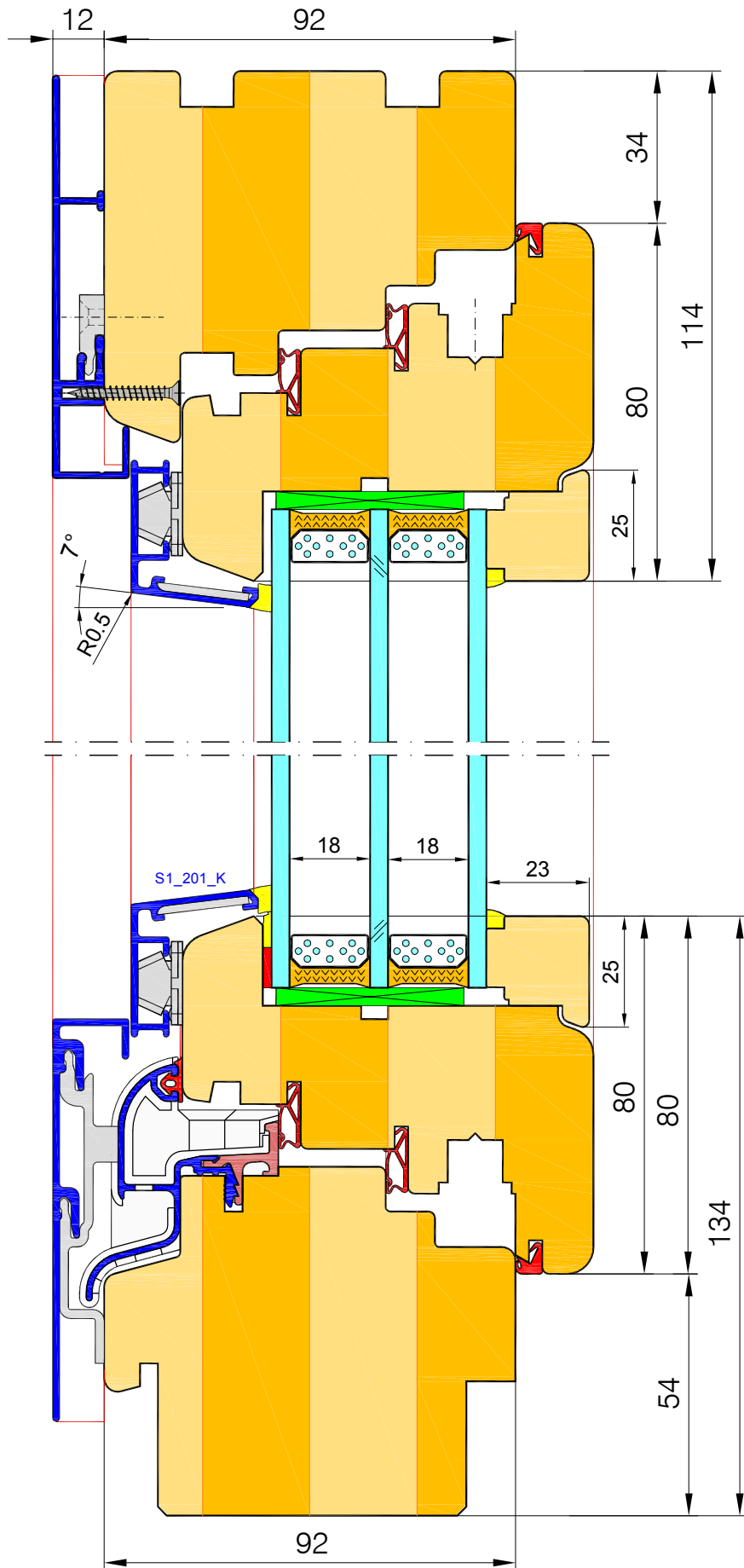

ELITE 92 ALU - Balcony doors inward opening with door handle & cylinder both sides.

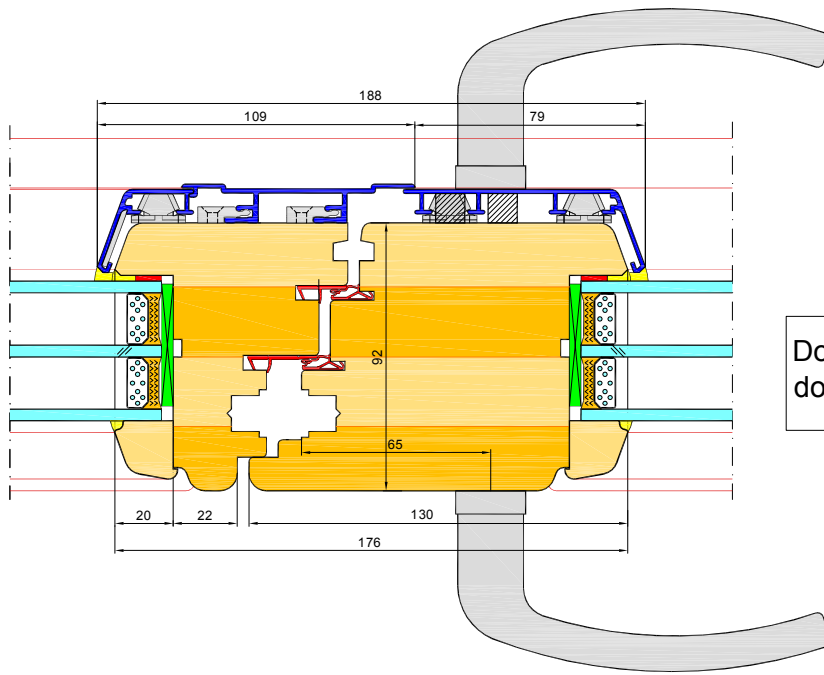

Double sash balcony doors with flying mullion

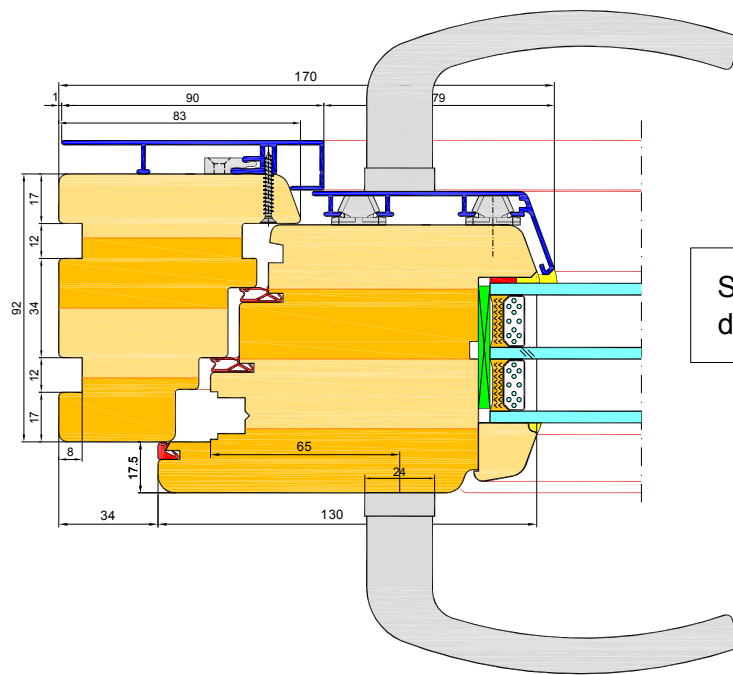

Single sash balcony doors

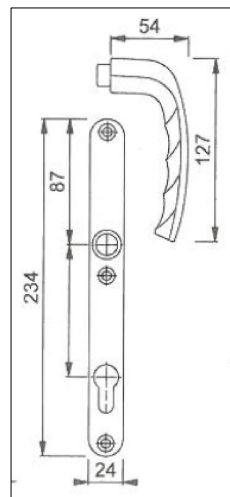

Corner connector 90°

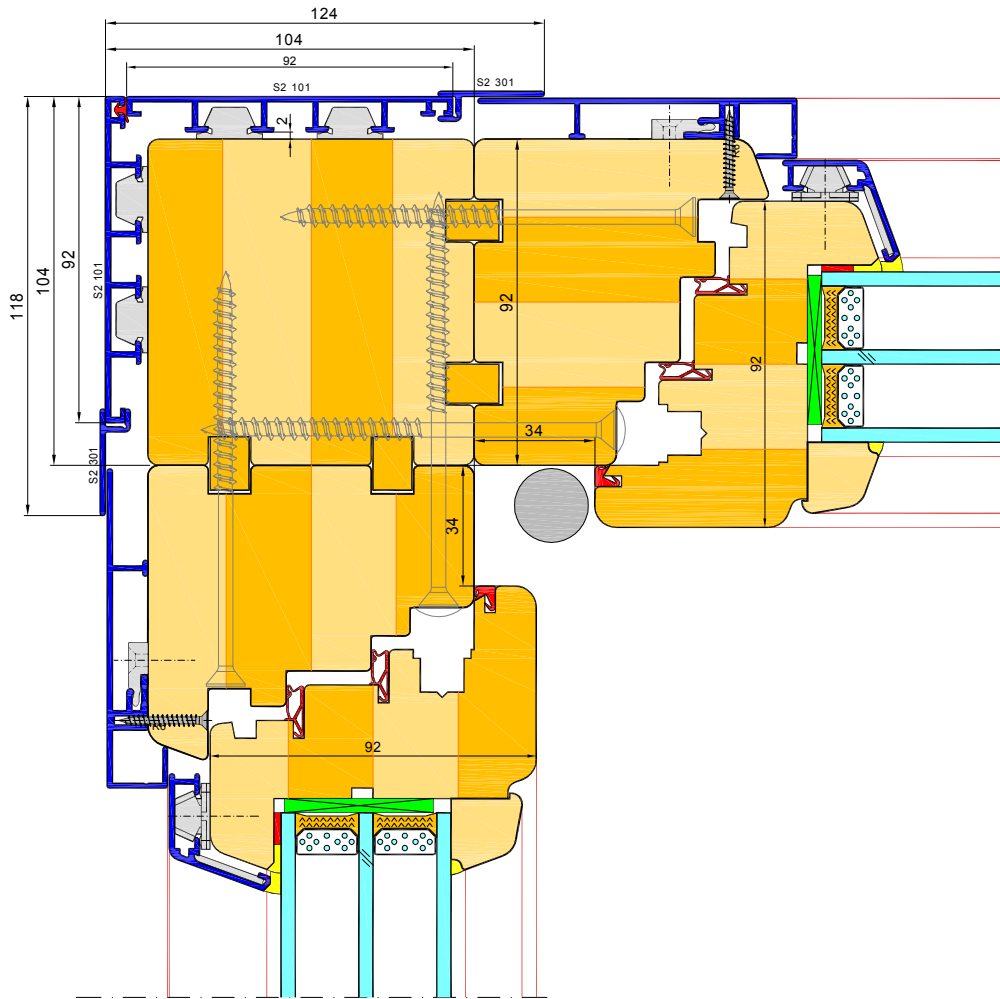

Corner connector 135°

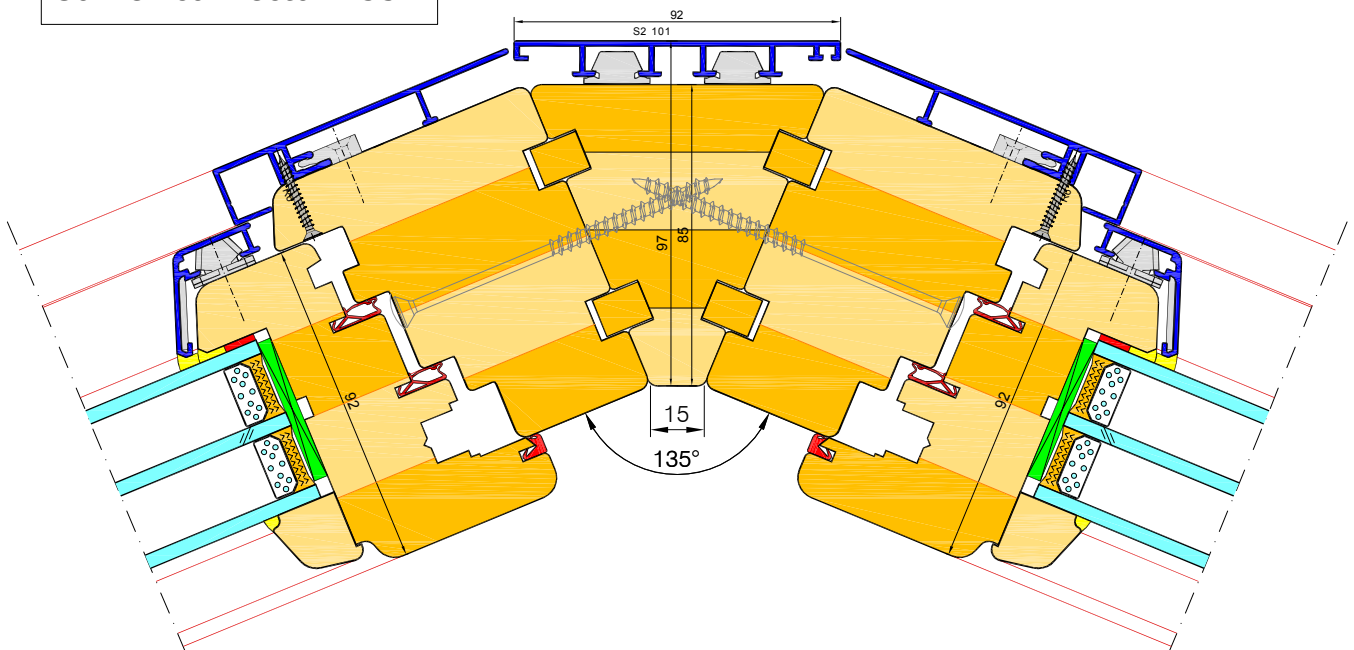

Window connection

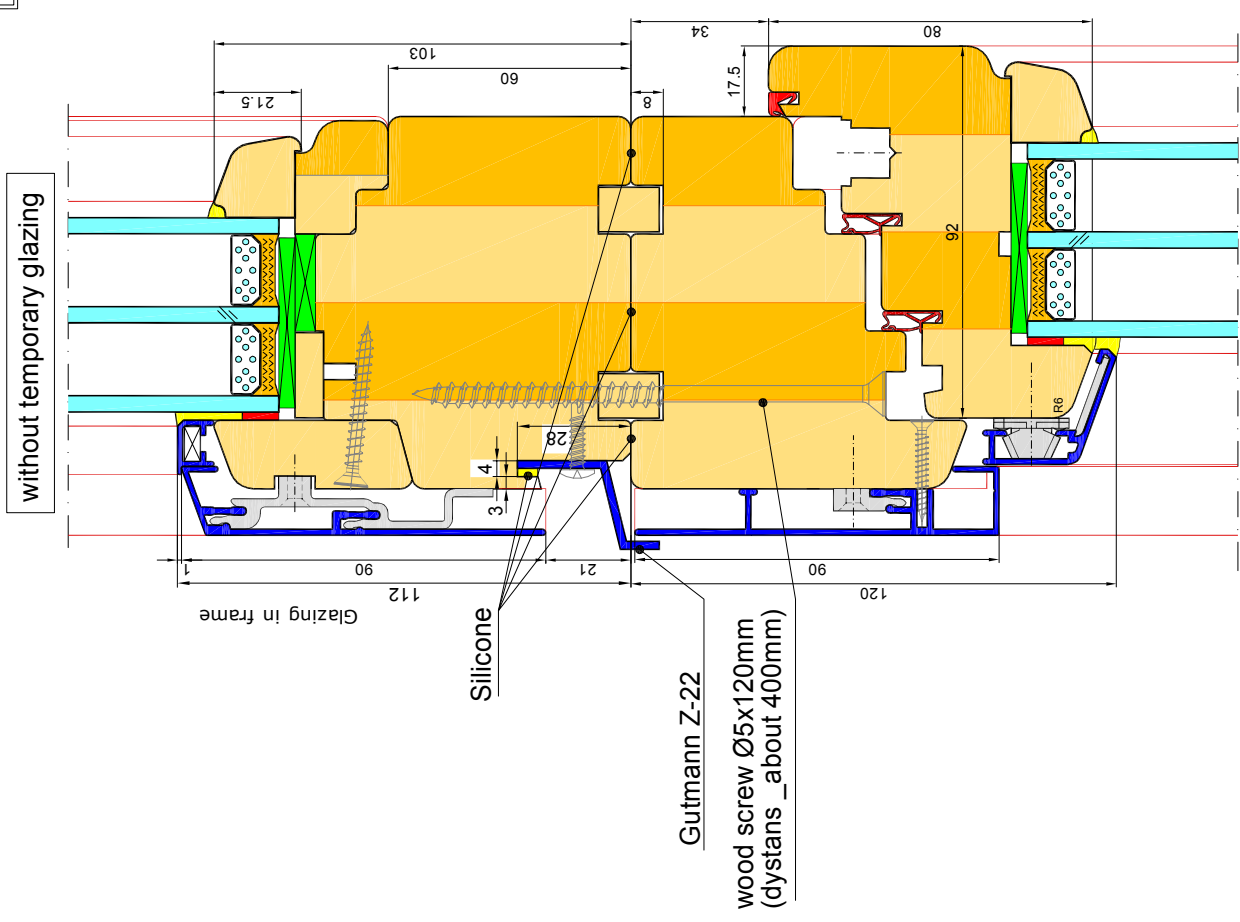
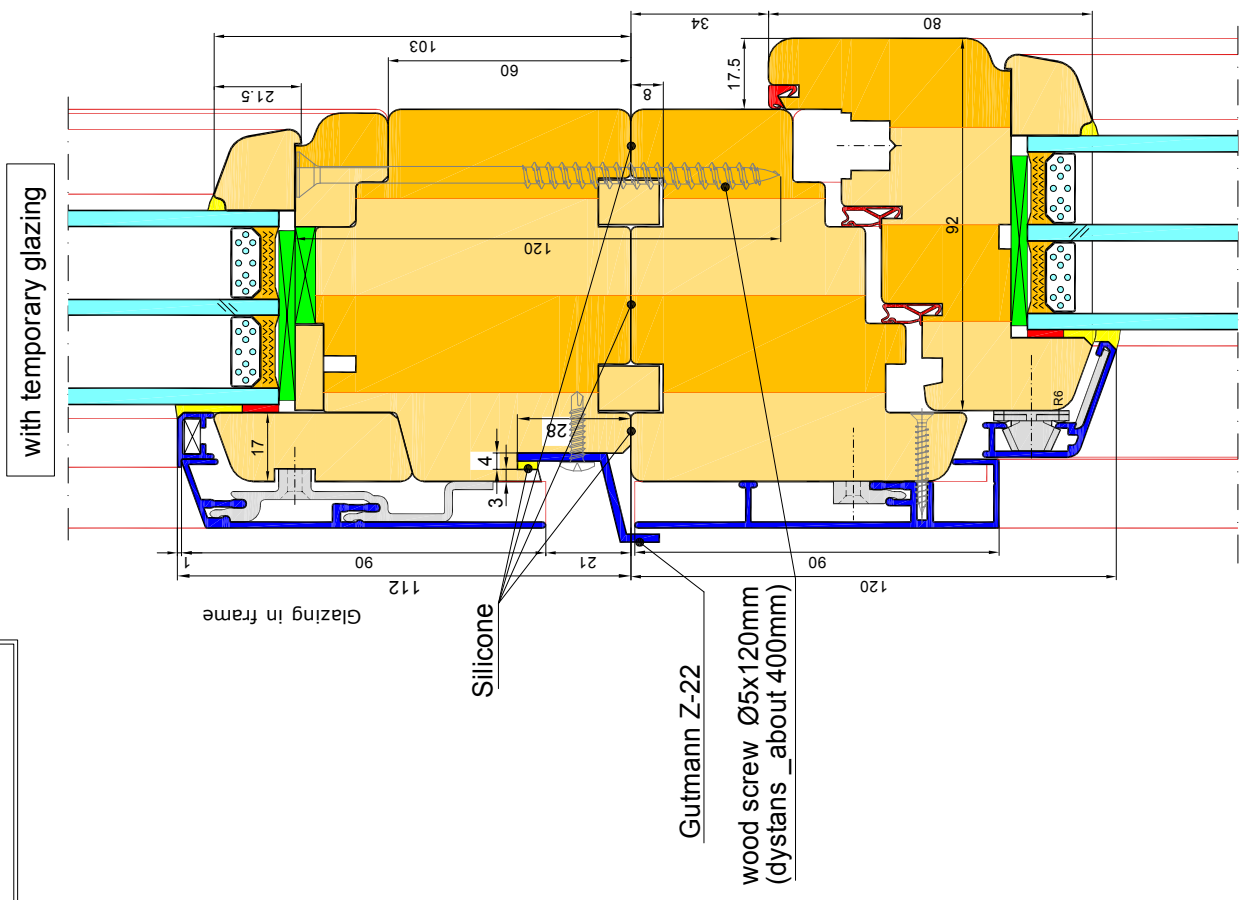

NOTE: make drilling for mounting screws. Hole diameter equal to screw core diameter.

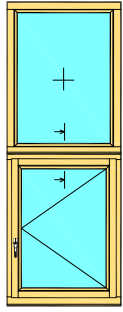

Fixedlight

silicone

Gutmann Z-22

wood screw
(dystans _about 400mm)

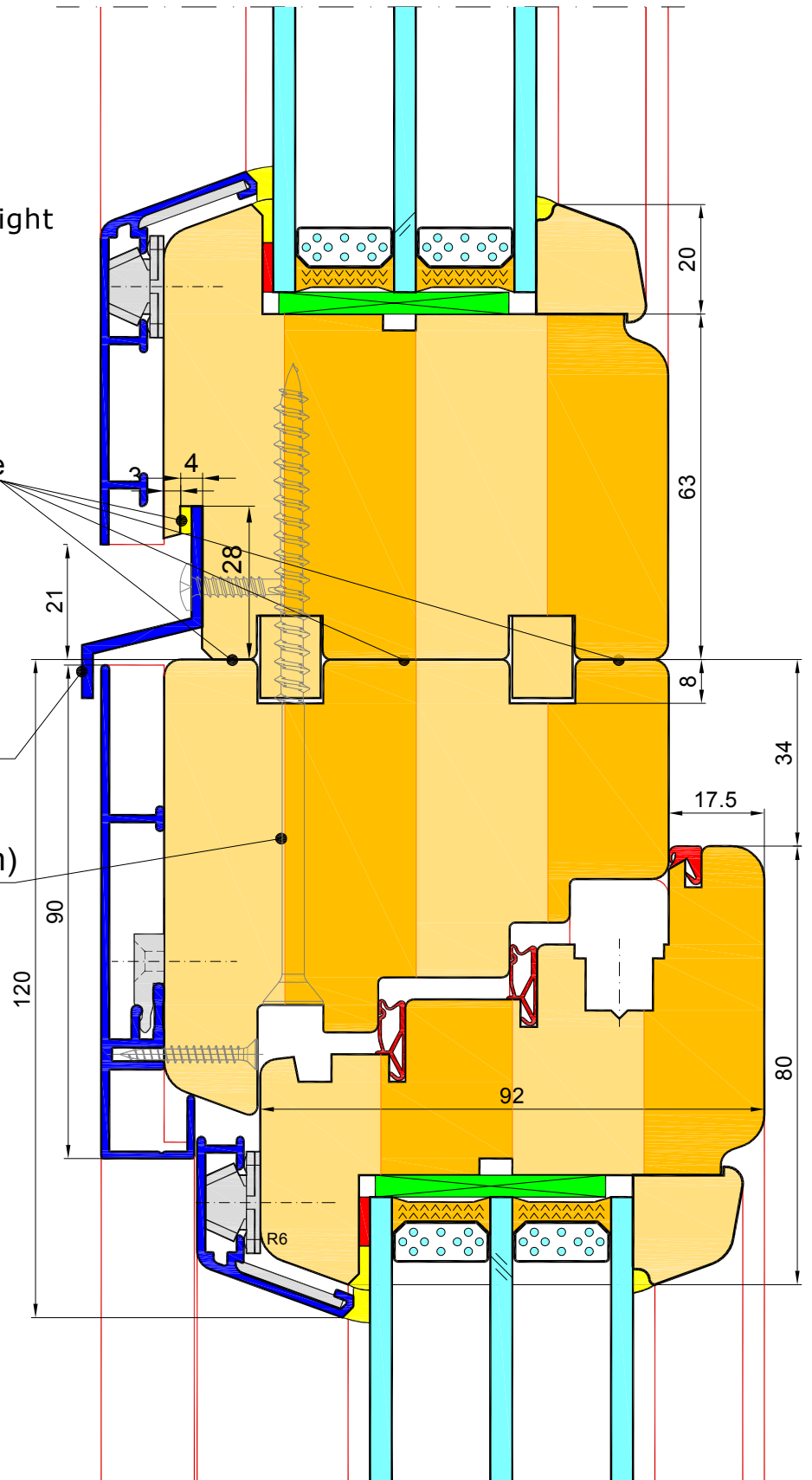

Reinforcing profile for window set 188 x 56mm.

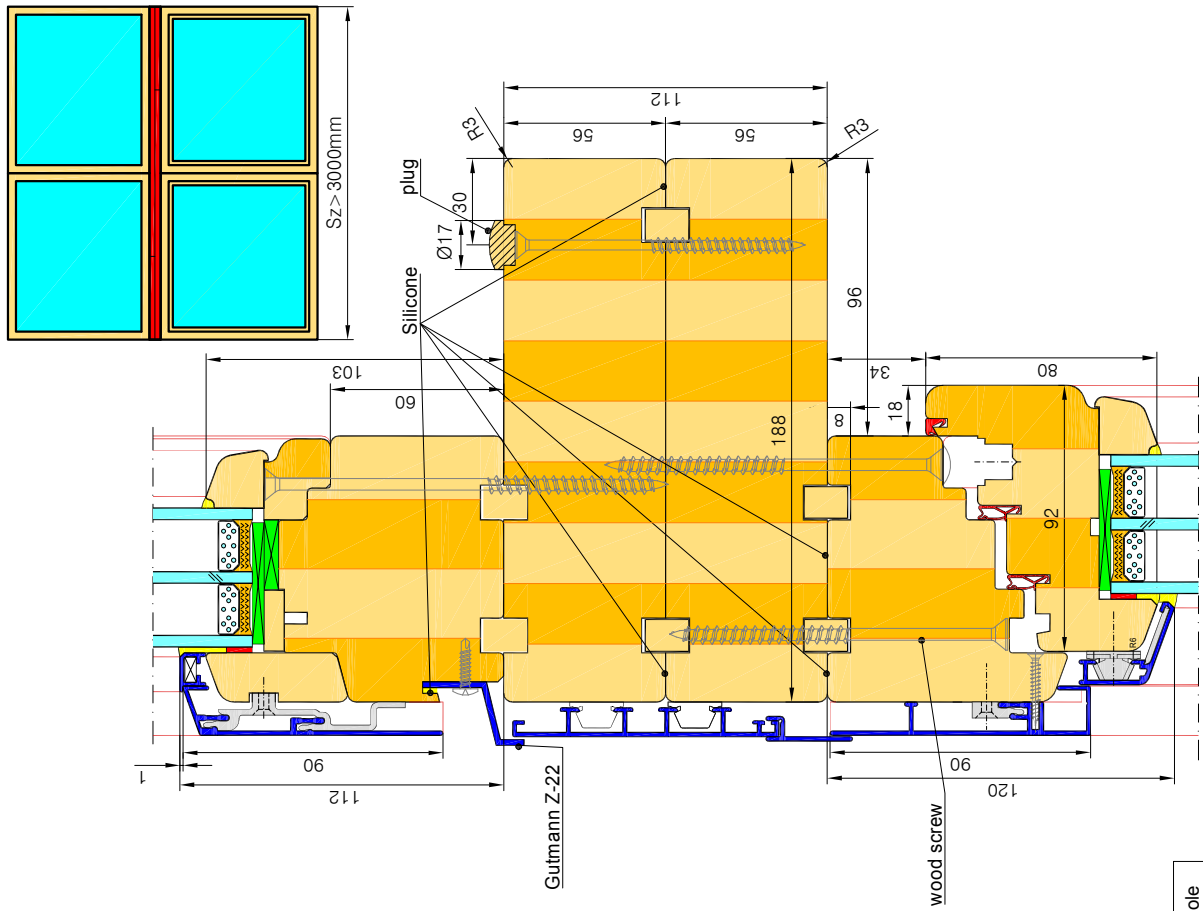

NOTE: make drilling for mounting screws. Hole diameter equal to screw core diameter.

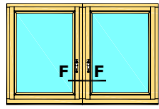

Window

F-F

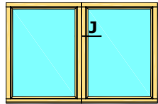
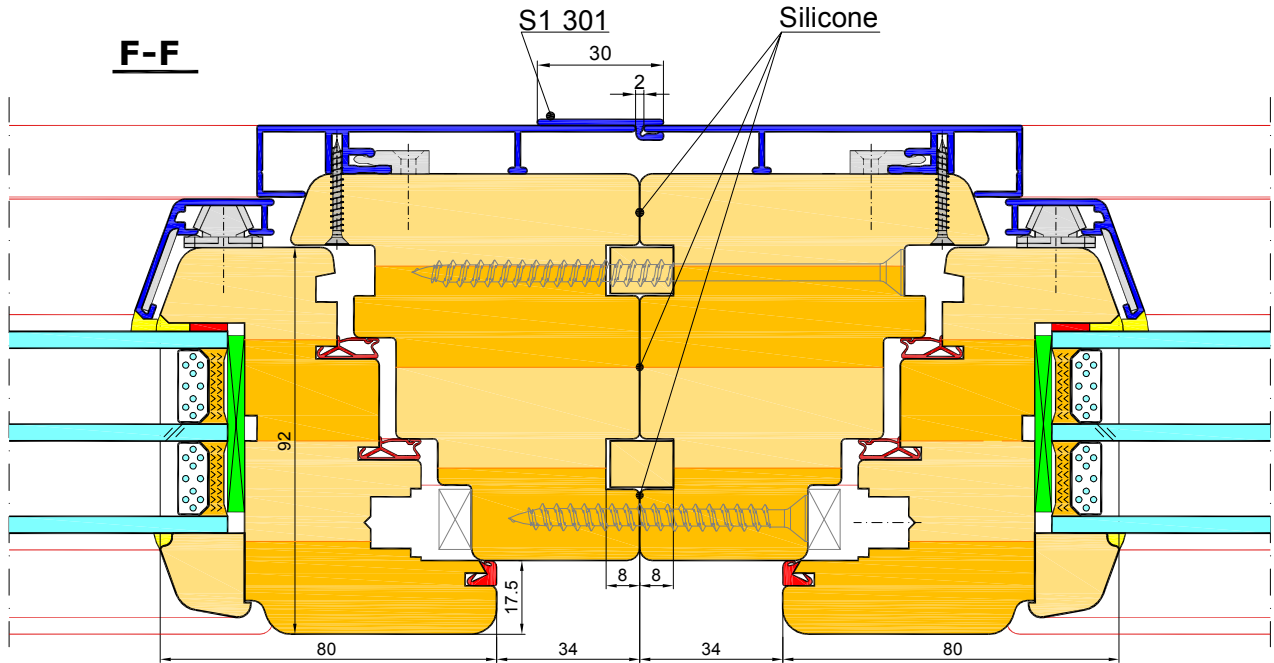

Fix

J-J

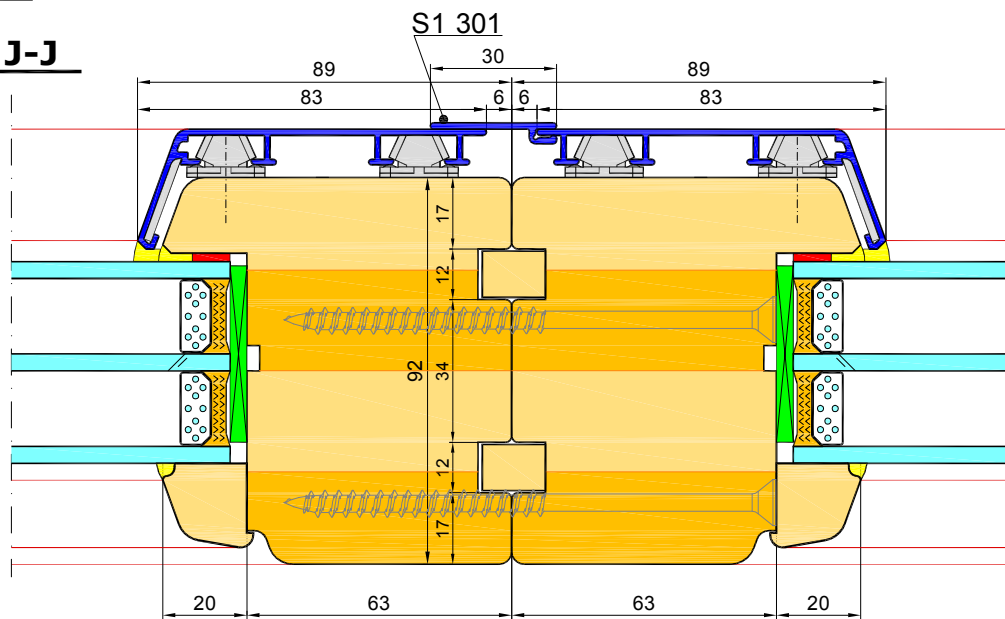

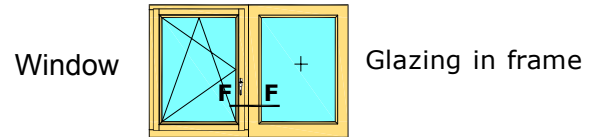

wood screw $\text{Ø}5 \times 120 \text{mm}$
(dystans _about 400mm)

F-F

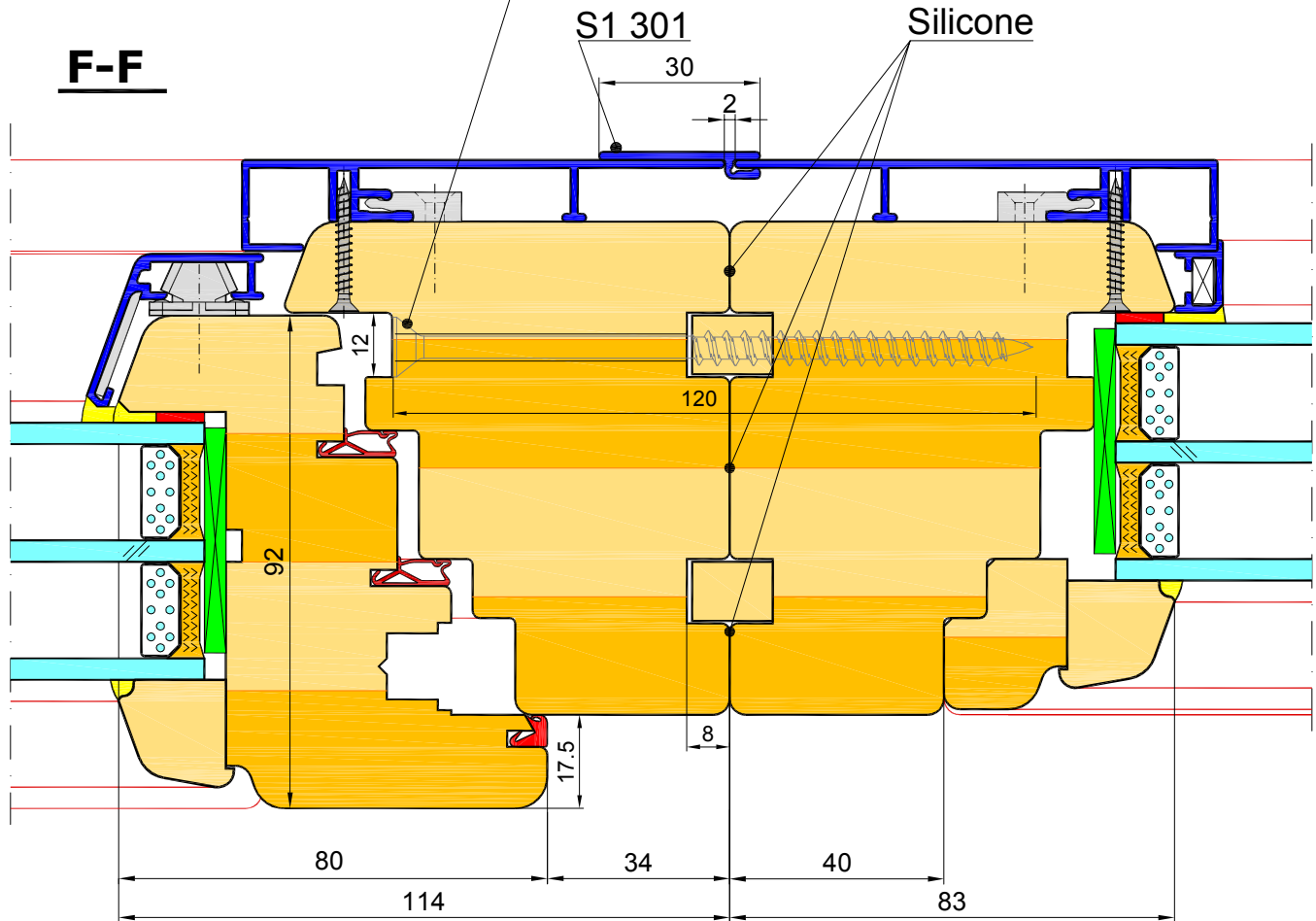

Counterprofile in frame

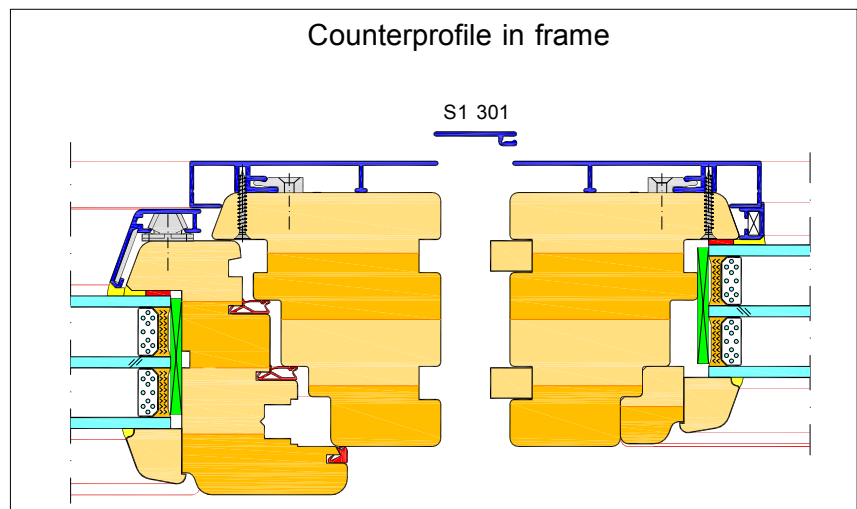

NOTE: make drilling for mounting screws. Hole diameter equal to screw core diameter.

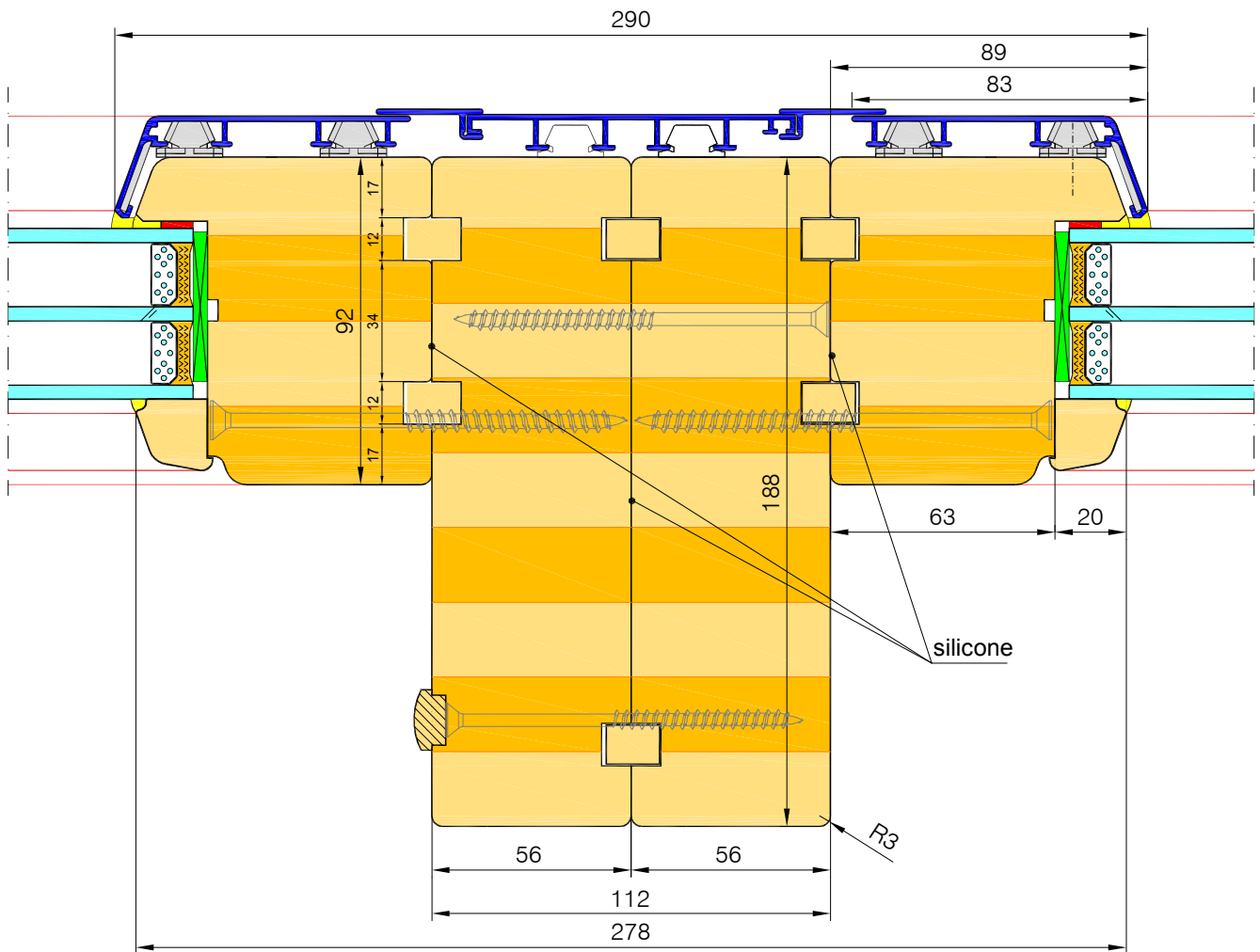
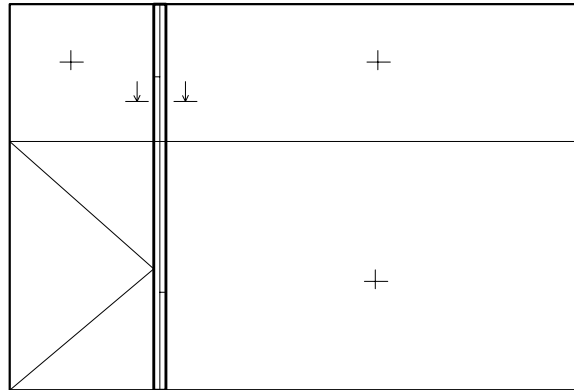

NOTE: make drilling for mounting screws. Hole diameter equal to screw core diameter.

Location of the EMM vent in the window cross section.

