

PURO PASSIVE - Windows and balcony doors.

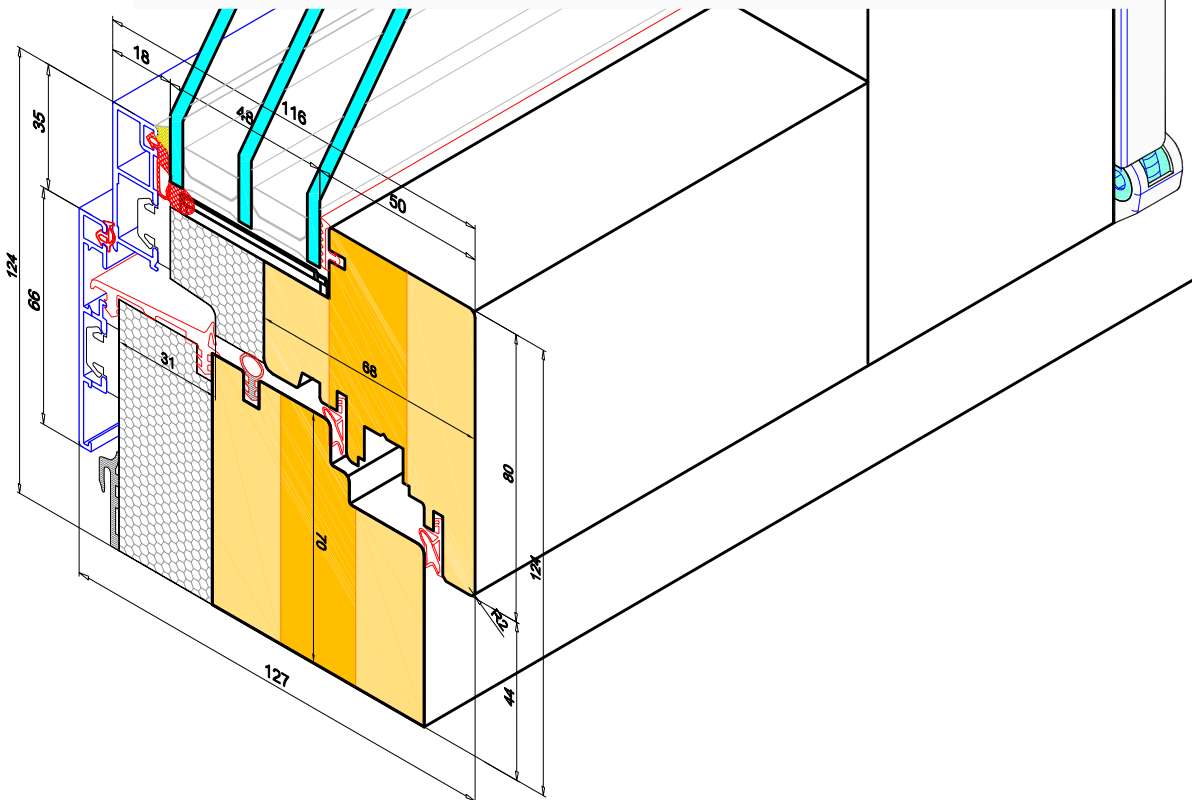

<i>L.p.</i>	<i>technical issue</i>	<i>description</i>	<i>notes</i>
1	CONSTRUCTION	PURO PASSIVE	
2	MATERIAL	- pine sorted (not fingerjointed), - oak,	
3	FITTINGS OPTIONS	- tilt, turn, turn&tilt, tilt&turn, - flying mullion with espagnolette, - tilt with HAU-TAU opener (from floor level), - anti-burglar options: RC1, RC2, - tilt and slide, - balcony doors with low aluminium threshold, - hidden hinges, - TBT handle function (tilt before turn),	
4	WINDOW SHAPE	Rectangle only	
5	SIZE RANGES	Sash width min.: 562mm, Sash height min. 562 - 2600mm Max sash weight 130kg - (tilt, tilt&turn).	
6	GLAZING UNITS	- glazing unit thickness: 47.5mm - 48.8mm	
7	TIMBER FINISH	Final painting with water-based opaque paints or stains	
8	COLOUR	- opaque: RAL 9016 (white), - Stain: Pine TM367, Afrozja TM4239, Mahogany TM1530, Palisander TM1705, Teak TM1703, Cyprys TM5207, Venge TM9012, Nut TM1515, Graphite TM1504,	
9	VENTS	a) Trimvent 90 HL 250; 425; 695 b) Trimvent S13 4000 c) Aereco,	
10	ADDITIONAL OPTIONS	- counterprofile, - thresholds, a) Cutting 11x30mm from inside, b) without cutting,	

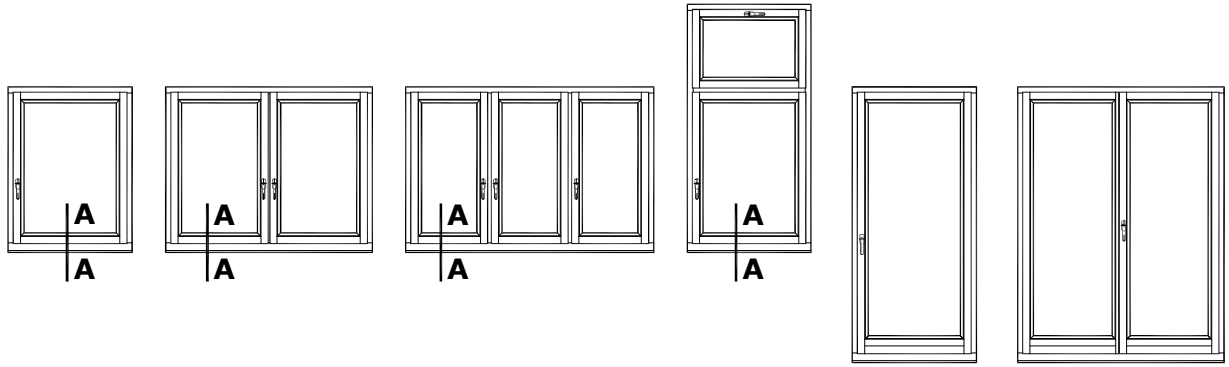

**A-A**

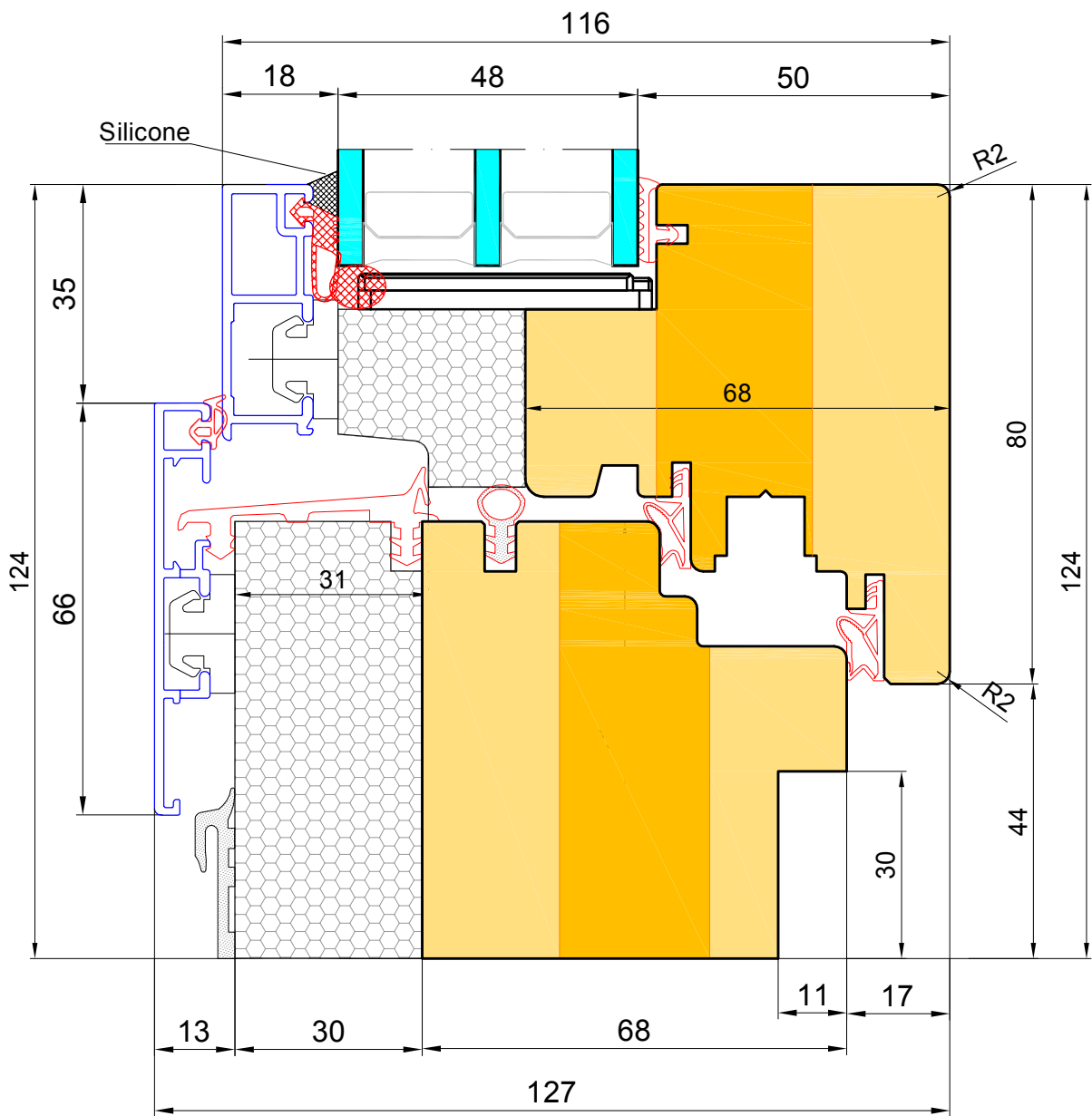

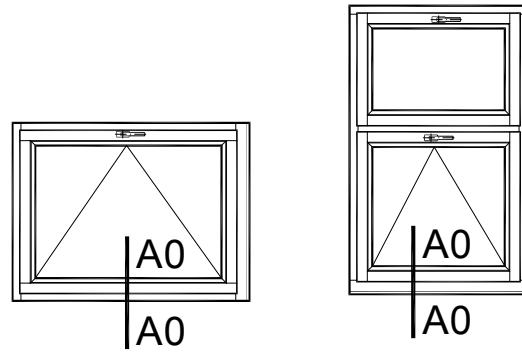

## A0-A0

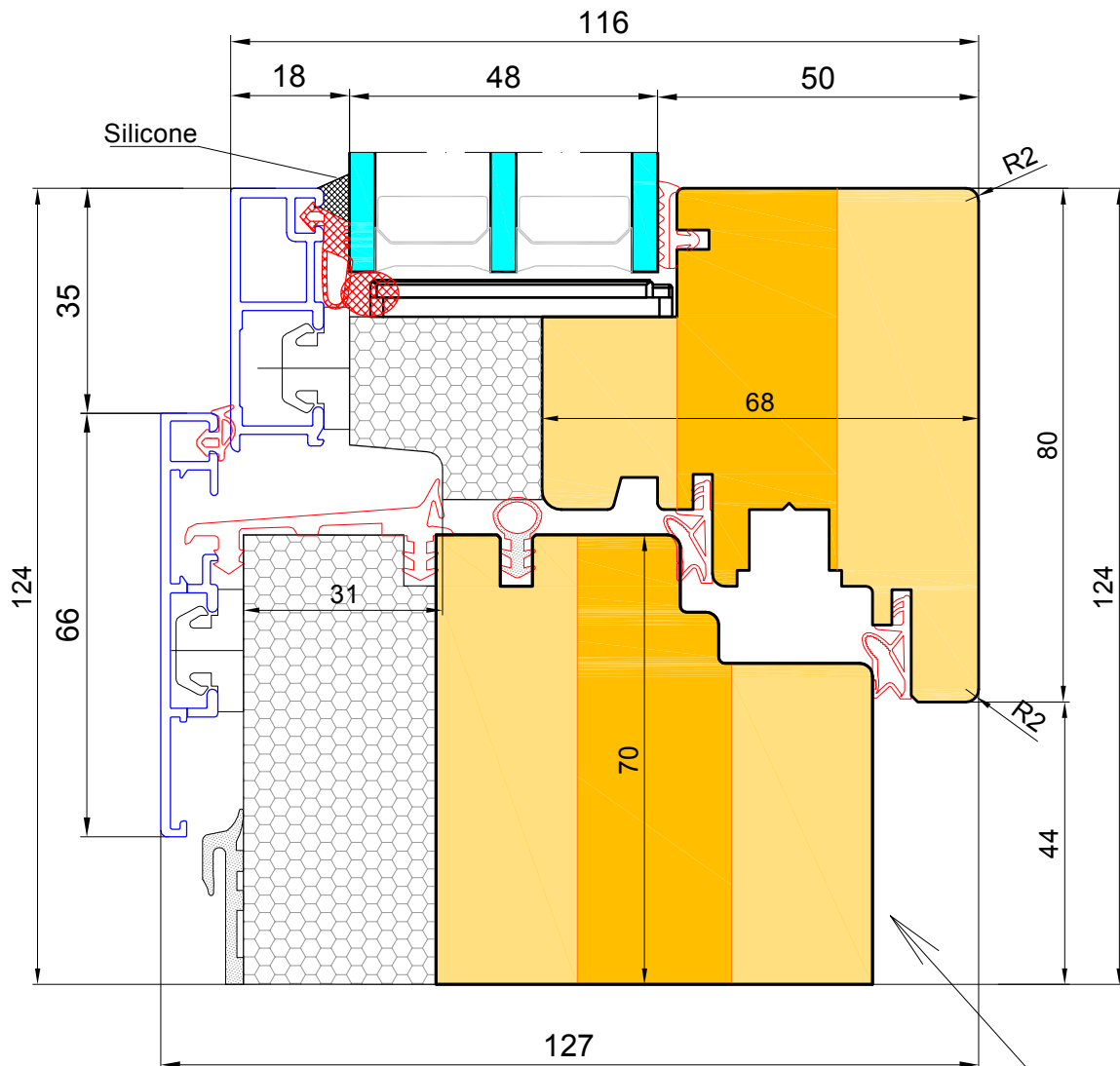

Note: no threshold cutting for tilt windows

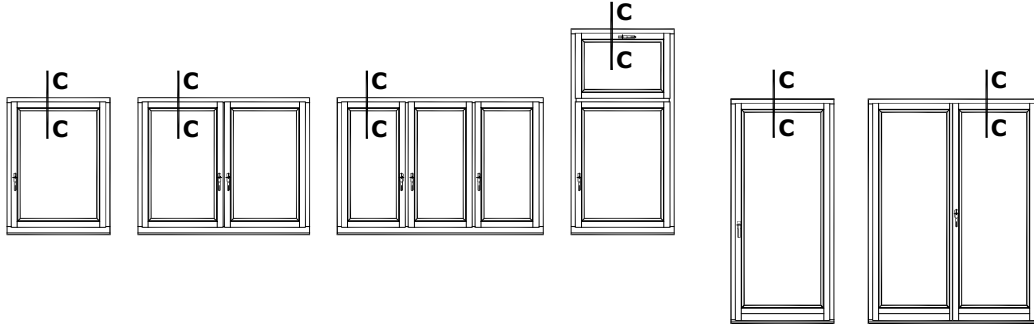

**C-C**

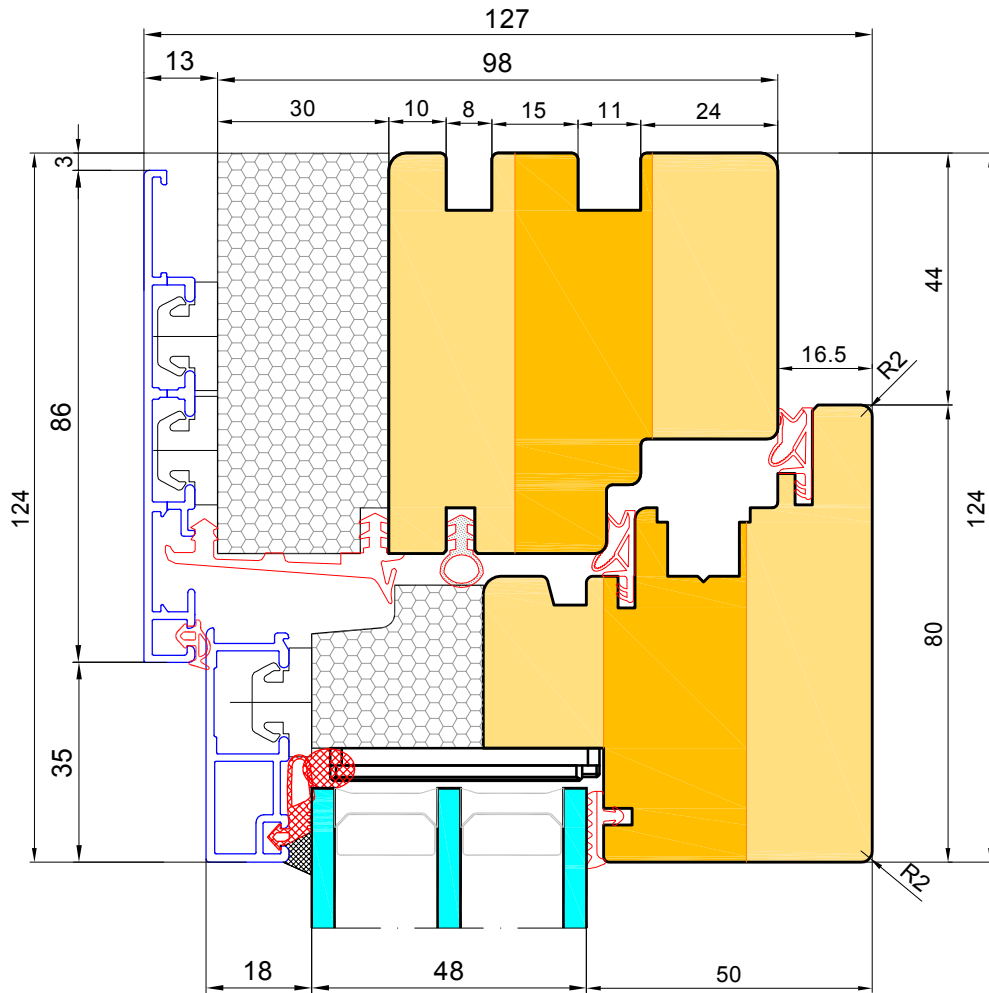

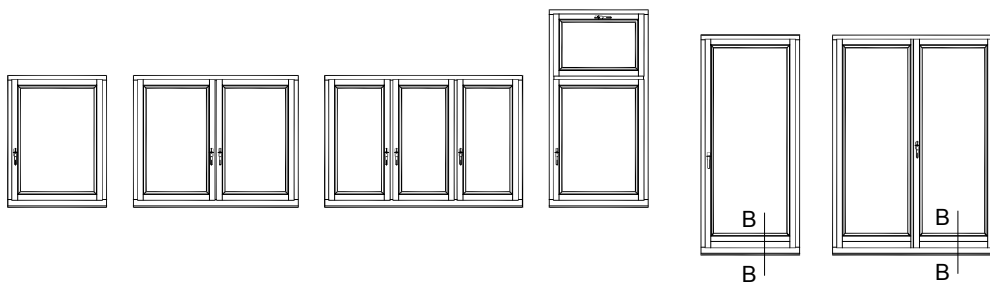

**B-B**

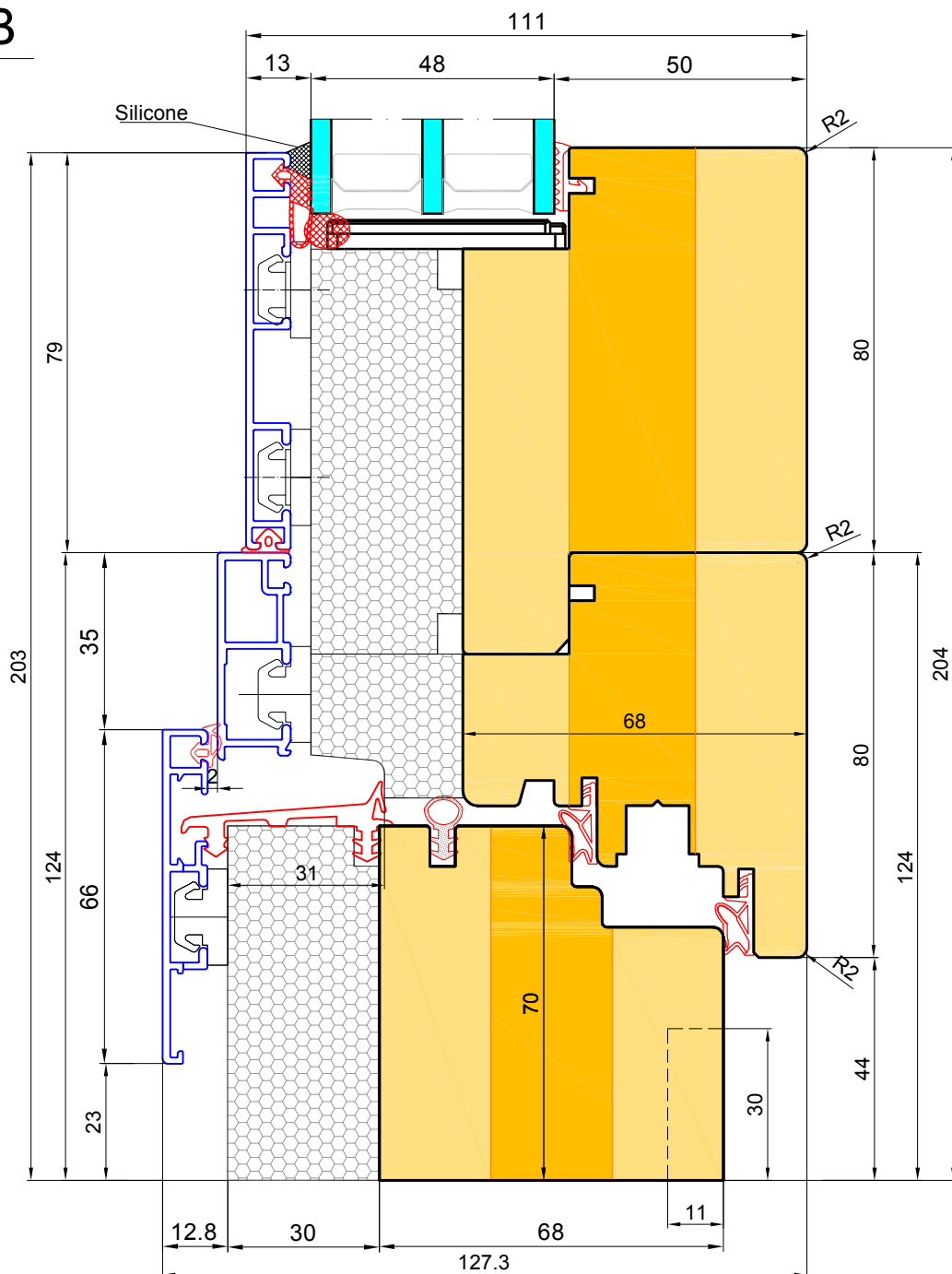

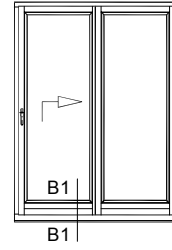

**B-B**

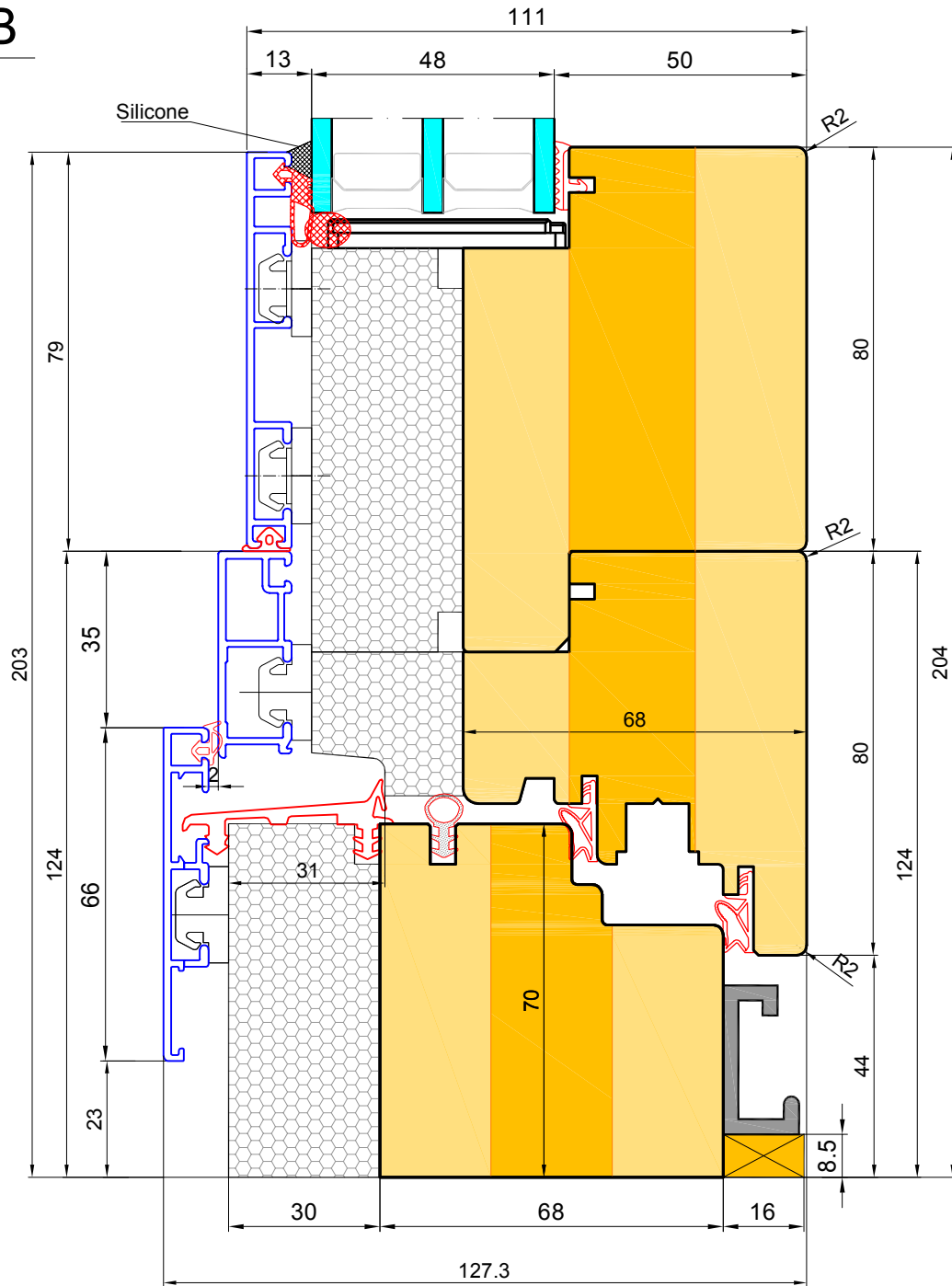

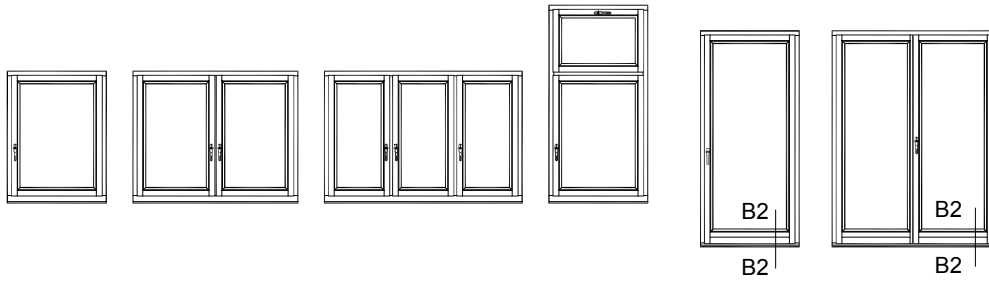

## B2-B2

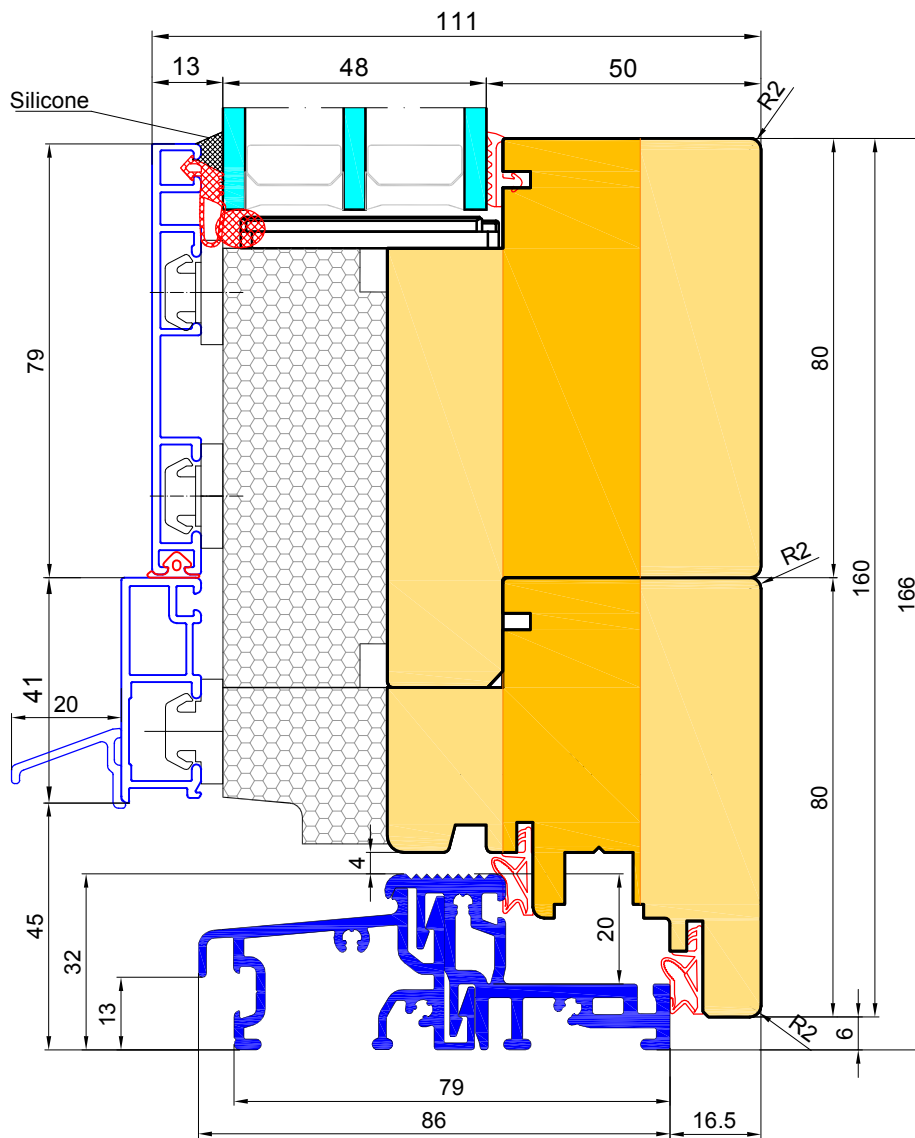

Low aluminium threshold.

Passivhouse certificate is not valid for this option



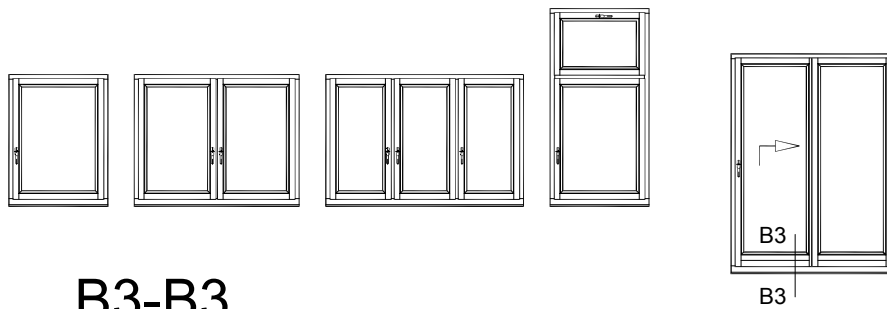

**B3-B3**

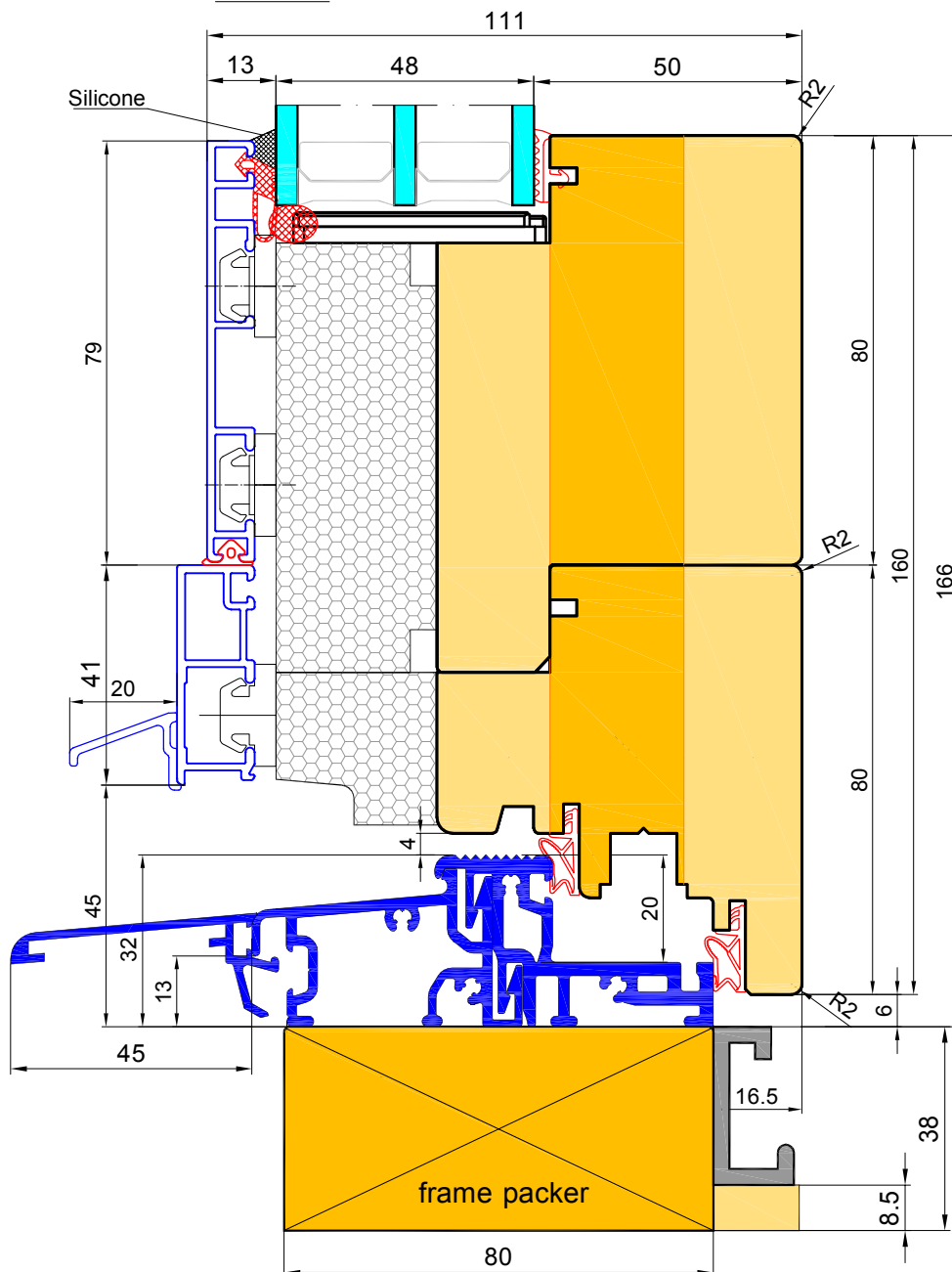

Low aluminium threshold.

Passivhouse certificate is not valid for this option

# A1-A1

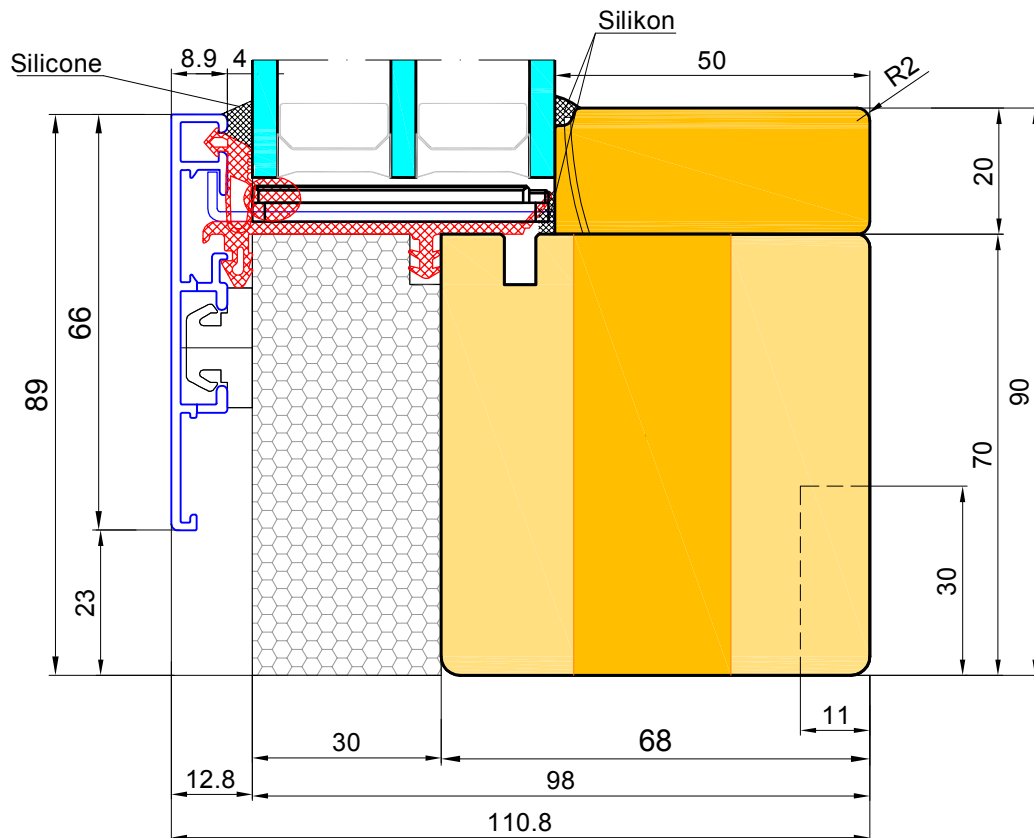
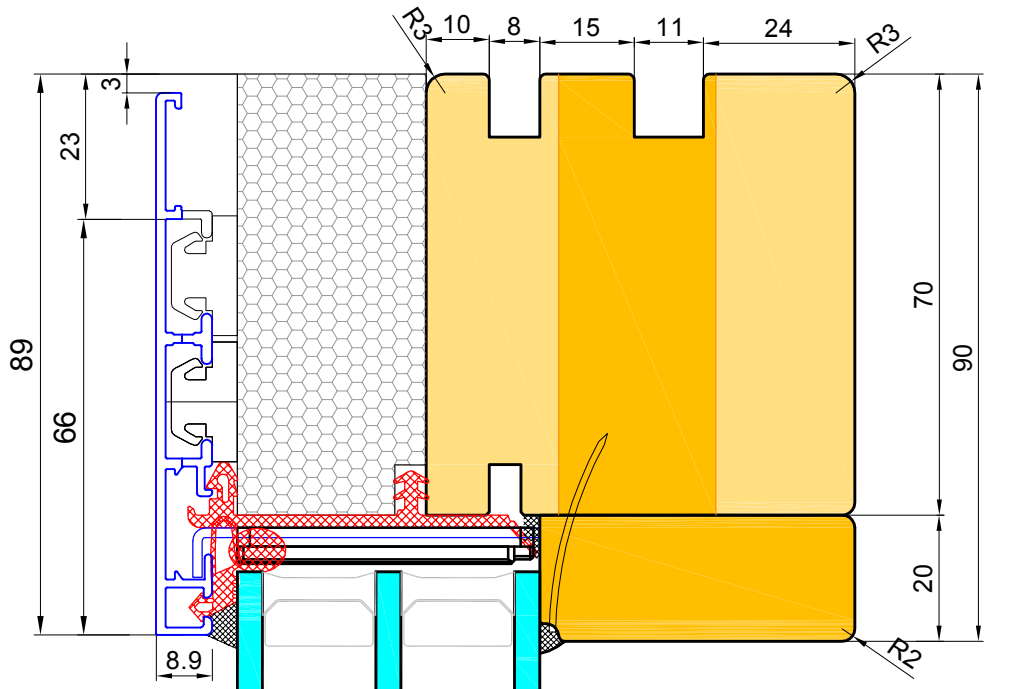
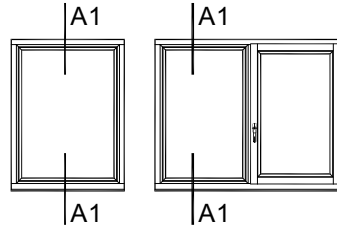

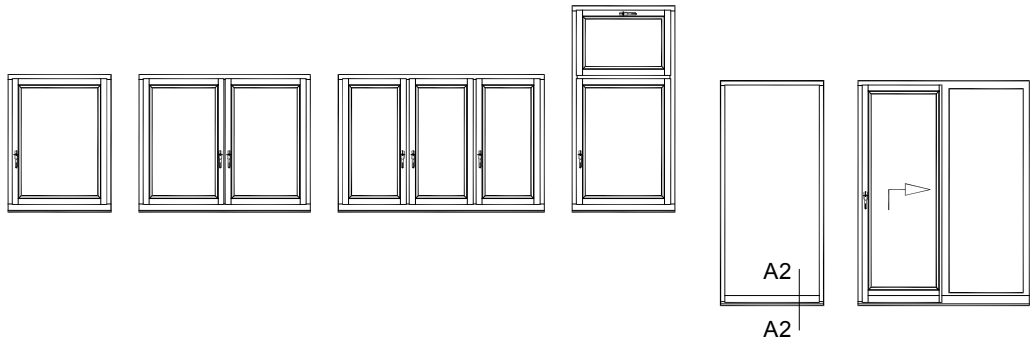

## A2-A2

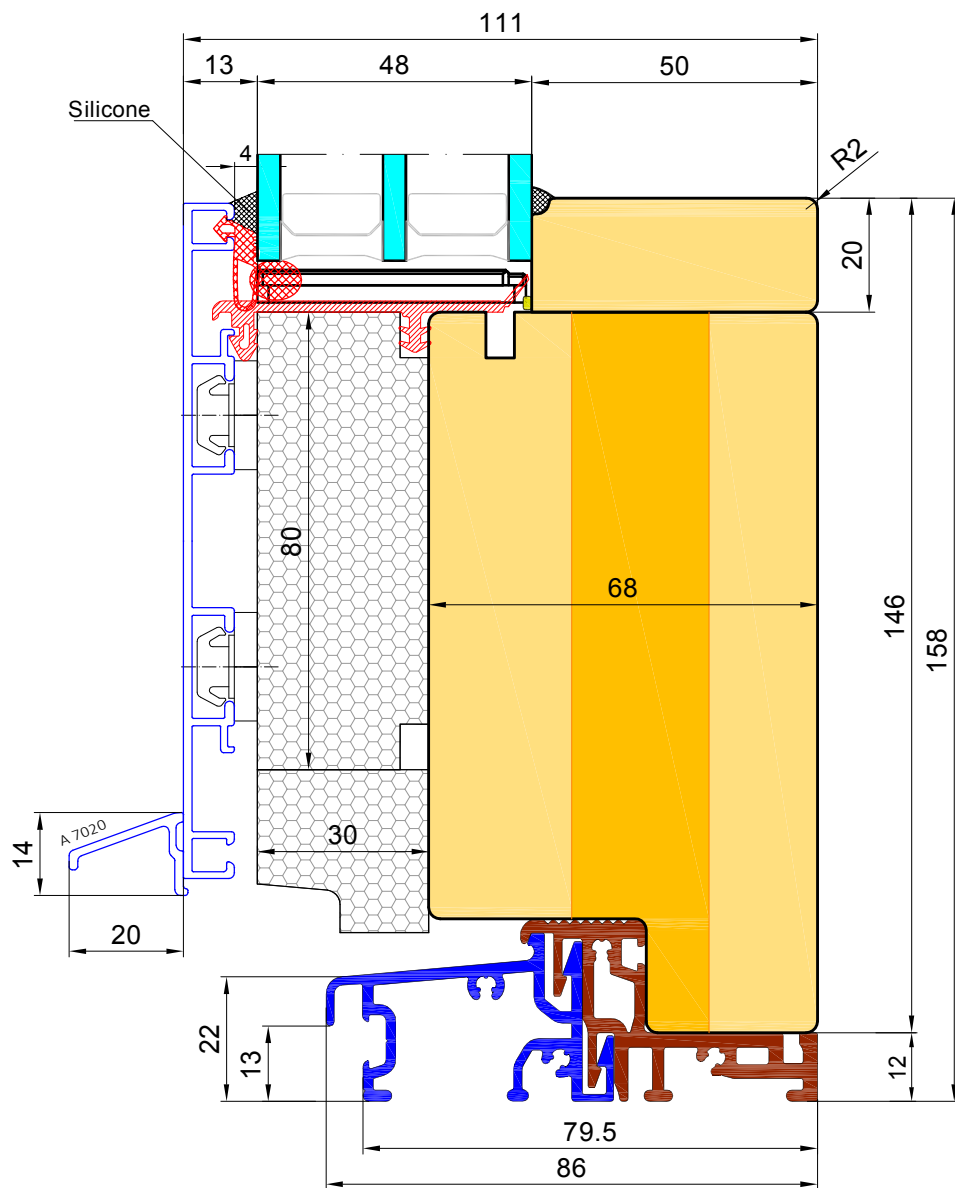

Low aluminium threshold.

Passivhouse certificate is not valid for this option

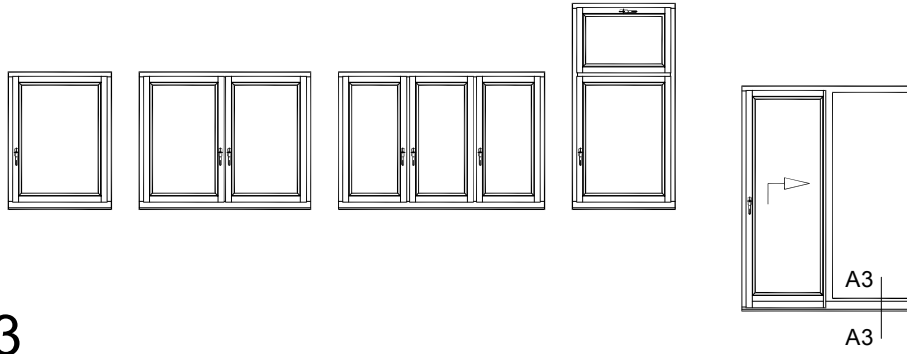

# A3-A3

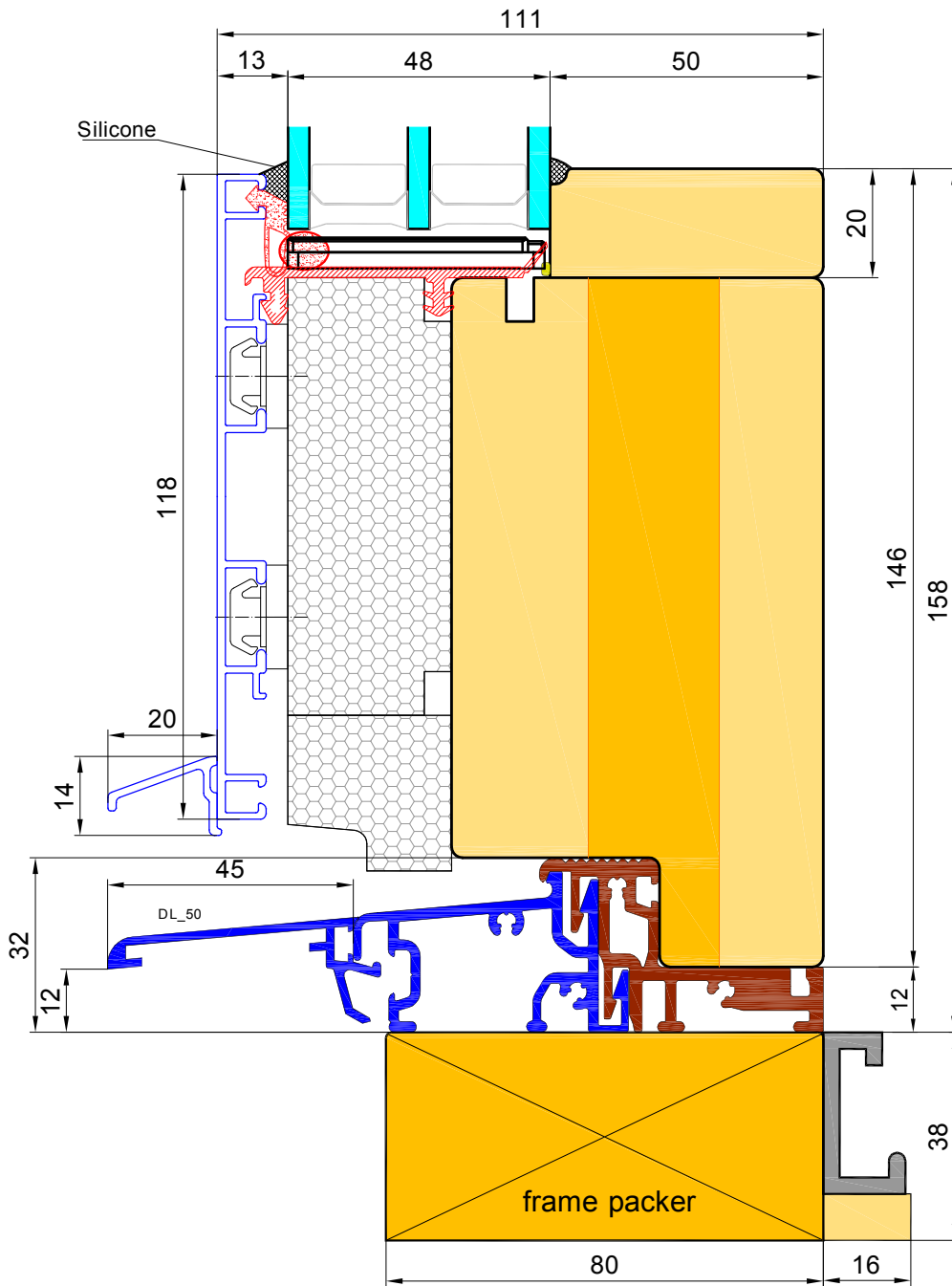

Low aluminium threshold.

Passivhouse certificate is not valid for this option

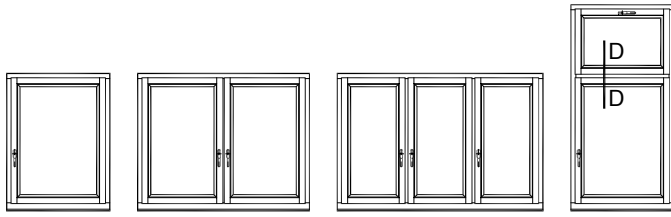

**D-D**

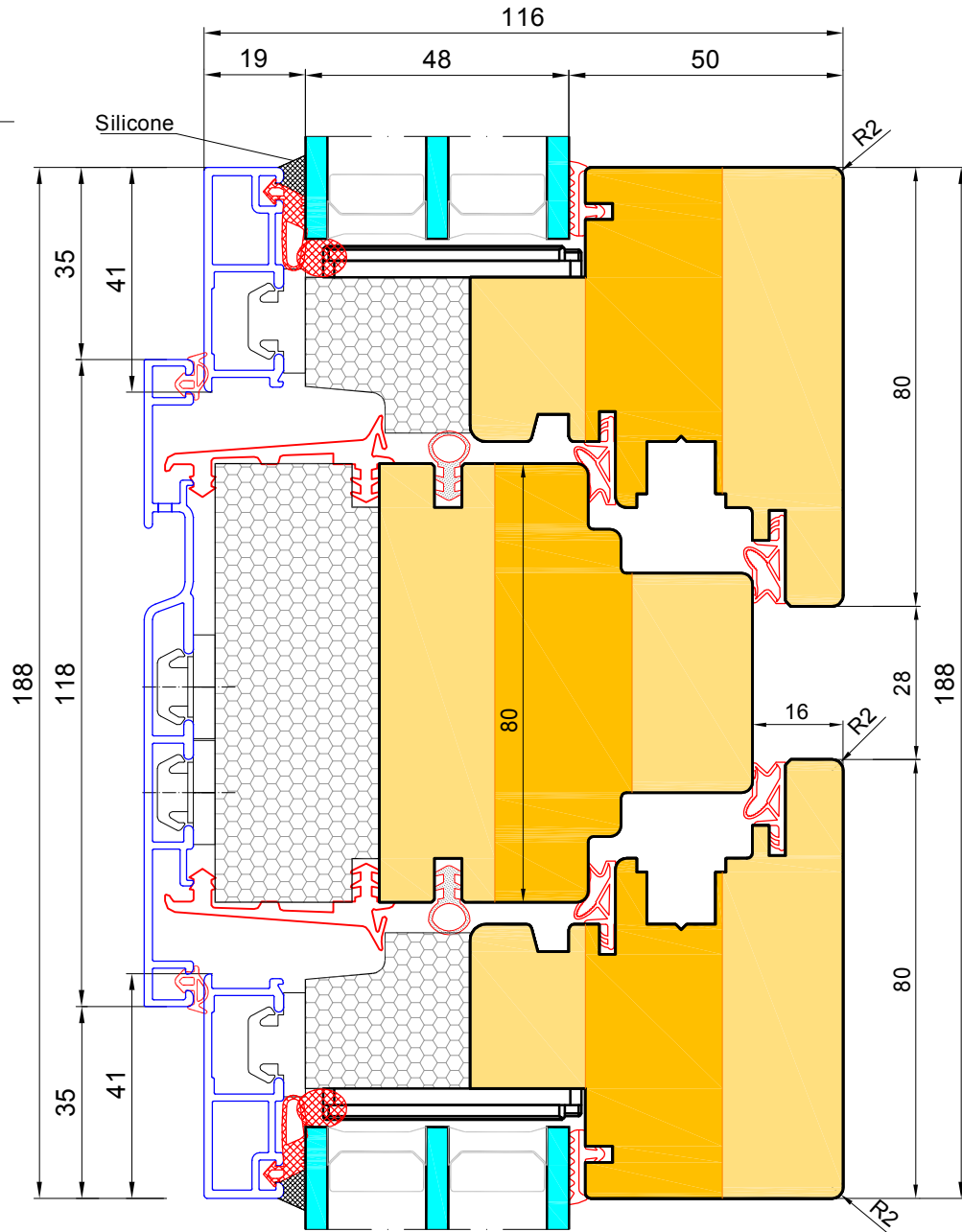

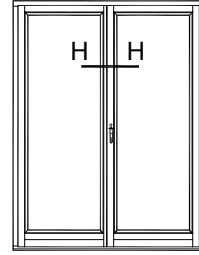

H-H

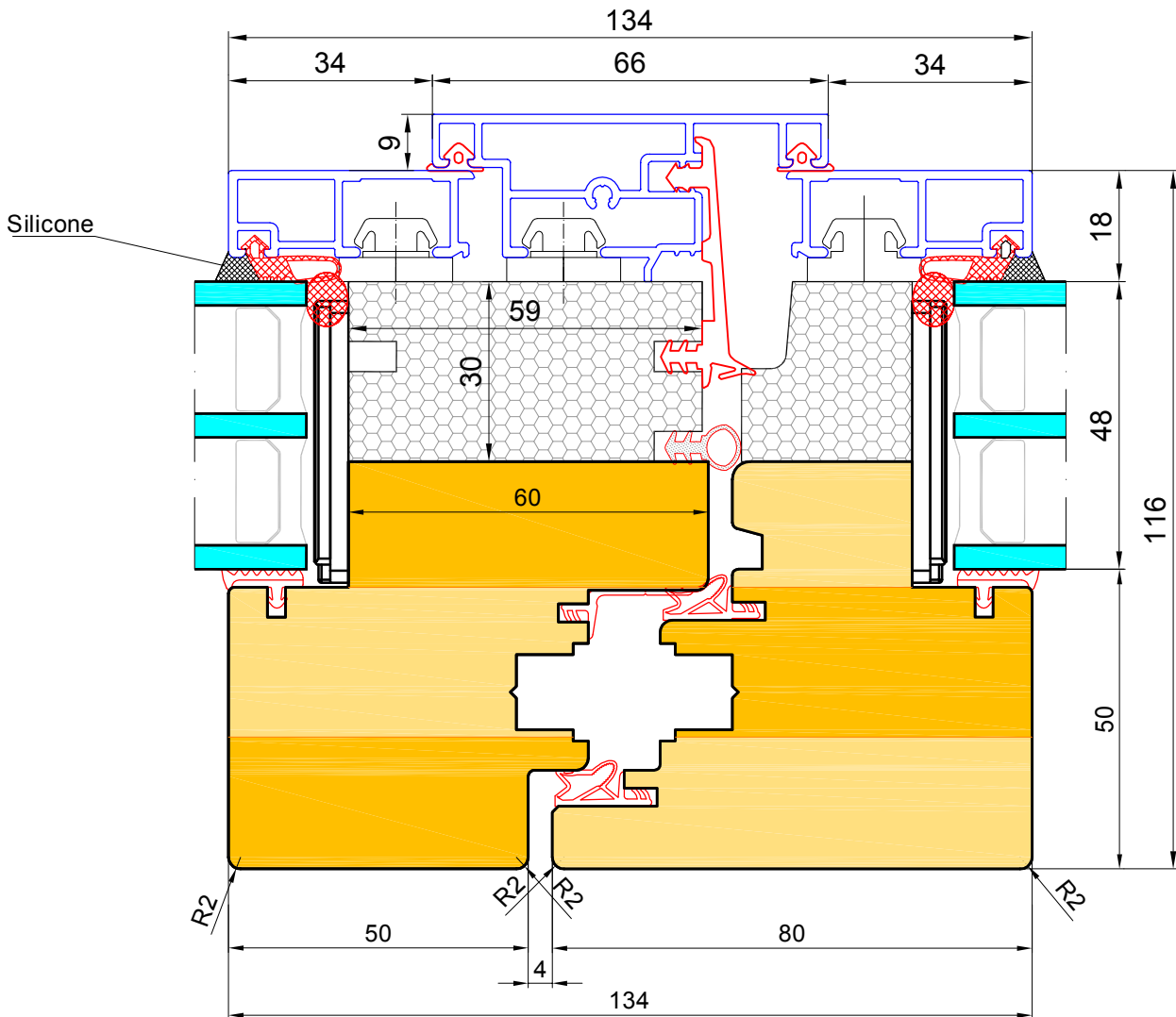

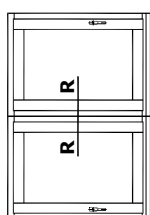

**R-R**

